

Marchington

Pergola 3 x 3 Assembly Guide



IMPORTANT: PLEASE REGISTER YOUR HEX LIVING PRODUCT AFTER ASSEMBLY

Using the unique serial number, simply register your product at www.hexliving.co.uk or use the QR code above to access the HEX Living lifetime warranty and online support.

Affix Serial Number
HERE



PLEASE READ THIS DOCUMENT FULLY PRIOR TO STARTING ASSEMBLY PROCEDURE

The objective of this instruction is to illustrate the recommended assembly sequence for this product, any deviation from this will be the sole responsibility of whoever carries out the assembly.

IMPORTANT: IT IS ADVISABLE THAT THE PRODUCT IS ASSEMBLED AT, OR AS CLOSE AS POSSIBLE TO WHERE IT WILL BE FINALLY LOCATED.

ENSURE THERE IS ADEQUATE CLEARANCE WHERE THE PRODUCT IS TO BE LOCATED:

Exterior dimensions (L x W x H)	3000 x 3000 x 2500mm
Footprint dimensions (L x W)	3000 x 3000mm

WE STRONGLY RECOMMEND USING A PERMANENT FIXING METHOD TO MOUNT THE PERGOLA ONTO A SOLID, FLAT SURFACE.

TWO PERSON ASSEMBLY

This well engineered contemporary pergola requires 2 people to assemble, time to complete in approximately 2-3 hours.



PERSONAL PROTECTION EQUIPMENT

We advise appropriate personal protective equipment is worn during assembly including eye protection and gloves.



Eye Protection









Gloves

CARING FOR YOUR HEX LIVING PRODUCT

Your **HEX Living** product is designed to stand the test of time, which is why we're happy to offer a lifetime warranty on our products. With zero maintenance required, simply assemble your HEX Living product and enjoy putting it to great use in your garden.

- Periodically, you might want to give your product a clean, these simple care tips are not essential to the performance of your product:
- Remove surface dirt with plain water using a jet wash or sponge, the coating on our products will ensure dirt or mud simply wipes away.
- Periodically clear the pergola's louvers and clever rainwater drainage system of fallen leaves.

WARNINGS AND ADVISORIES

-  **To install this pergola technical knowledge is necessary. Do not mount this pergola yourself, but contact a professional workman for help if you do not have necessary technical knowledge, or unable understand the assembly manual.**
-  **Do not try to install the pergola alone. If the pergola falls, it could cause serious injuries and damages!**
-  **Select a dry and calm day for your assembly, do not try to install the pergola in windy conditions!**
 - Please read the manual carefully before assembling, (we recommend keeping the manual for future use).
-  **We advise a flat hard floor surface, preparing suitable area for assembly. If the floor shows any sign of cracks, consult a professional.**
 - Place all parts out carefully, ideally on a soft surface to protect parts from getting damaged.
 - Please check part quantities before assembling, contact customer service if any parts are missing or damaged.
-  **When the louvers are closed, we strongly advise you stop turning the handle immediately to avoid damage to internal components and metal parts. (Please note: failing to do so could affect future warranty claims on moving parts).**
-  **Always keep the pergola louvers open and side screens up during heavy winds or extreme weather conditions to avoid damage to the pergola.**
-  **Allowing people to climb onto the pergola or hanging anything from this product will affect your warranty!**

PRODUCT REGISTRATION

-  **IMPORTANT:** Thank you for purchasing our **Marchington Pergola**, ensure you have registered your HEX Living product using the unique serial number found on the cover of this document, please visit **www.hexliving.co.uk** to register your product and access the HEX Living lifetime warranty.

Pergola 3 x 3 Assembly Guide

ENSURE ALL ITEMS LISTED ARE PRESENT PRIOR TO STARTING ASSEMBLY PROCEDURE.
SCALE OF ITEMS WILL VARY TO AID VISUAL IDENTIFICATION.

Part Ref: 0230-157
Qty: x4

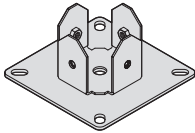

Part Ref: 0230-173
Qty: x4

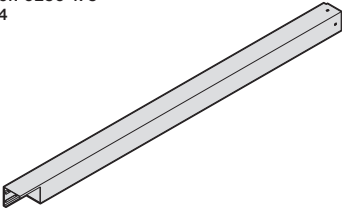

Part Ref: 0230-102
Qty: x2

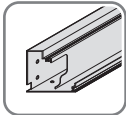
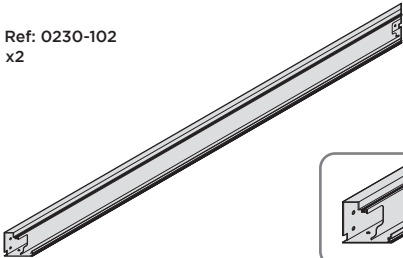

Part Ref: 0230-103
Qty: x1

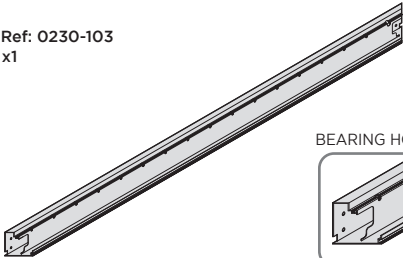

BEARING HOLES

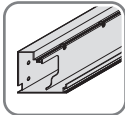

Part Ref: 0230-136
Qty: x1

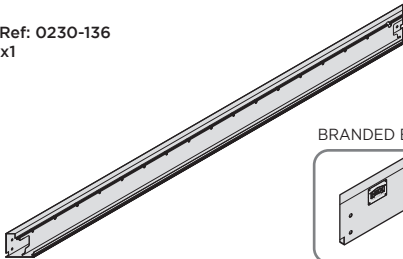

BRANDED BEAM

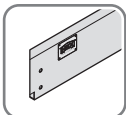

Part Ref: 0230-161
Qty: x1

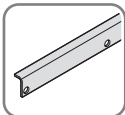
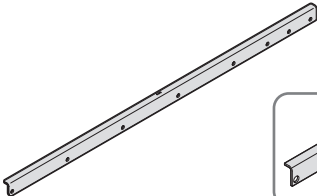

Part Ref: 0230-162
Qty: x1

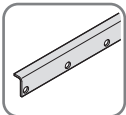
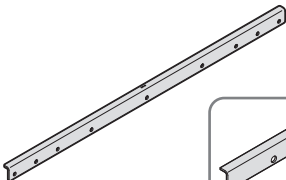

Part Ref: 0230-163
Qty: x1

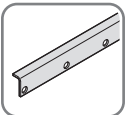
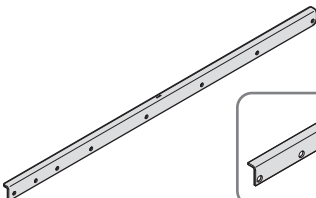

Part Ref: 0230-164
Qty: x2

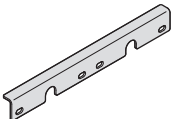

Pergola 3 x 3 Assembly Guide

ENSURE ALL ITEMS LISTED ARE PRESENT PRIOR TO STARTING ASSEMBLY PROCEDURE.
SCALE OF ITEMS WILL VARY TO AID VISUAL IDENTIFICATION.

Part Ref: 0230-165
Qty: x3

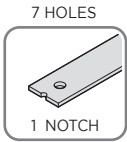
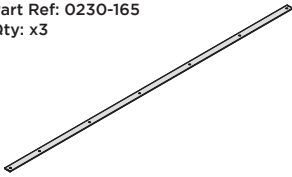

Part Ref: 0230-166
Qty: x3

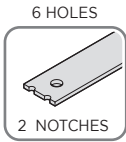
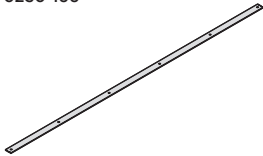

Part Ref: 0230-171
Qty: x16

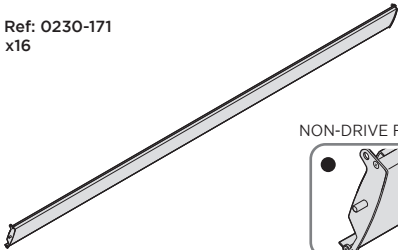

Part Ref: 0230-174
Qty: x1

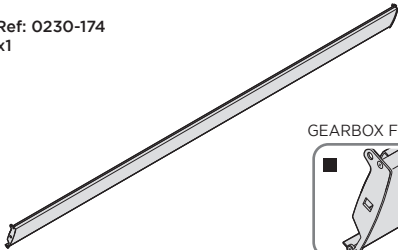

Part Ref: 0230-116
Qty: x1

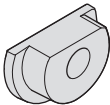

Part Ref: 0230-113
Qty: x32



Part Ref: 0230-134
Qty: x1



Part Ref: 0230-167
Qty: x1



Part Ref: 0230-119
Qty: x1

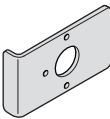

Part Ref: 0230-121
Qty: x1

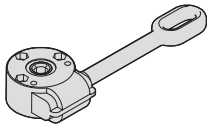

Part Ref: 0230-177
Qty: x1

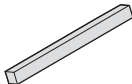

Part Ref: 0230-123
Qty: x1

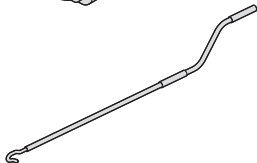

Part Ref: 0230-110
Qty: x4

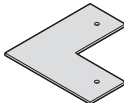

Part Ref: 0230-131
Qty: x1

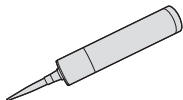

Pergola 3 x 3 Assembly Guide

ENSURE ALL ITEMS LISTED ARE PRESENT PRIOR TO STARTING ASSEMBLY PROCEDURE.
SCALE OF ITEMS WILL VARY TO AID VISUAL IDENTIFICATION.

Part Ref: 0230-168
Qty: x1

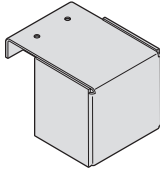

Part Ref: 0230-149
Qty: x8



Part Ref: 0230-118
Qty: x8



Part Ref: 0230-135
Qty: x4

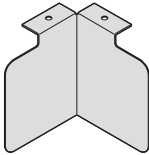

Part Ref: 0230-150
Qty: x2

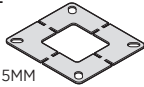

Part Ref: 0230-151
Qty: x2

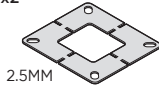

LED LIGHTING KIT - 12M: 0230-122

Part Ref: 0230-122-01
Qty: x1



Part Ref: 0230-122-02
Qty: x4

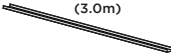

Part Ref: 0230-122-04
Qty: x1

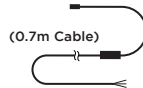

Part Ref: 0230-122-03
Qty: x1

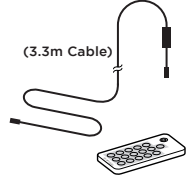

Part Ref: 0230-122-05
Qty: x1

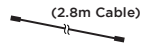

GROUND FIXING KIT: 0230-155

Part Ref: 0230-154
M8 x 80mm Hex Head Set Screw
Qty: x16



Part Ref: 0230-153
M8 Washer
Qty: x16



Part Ref: 0230-152
M8 Anchor Shield
Head Screw Qty: x16

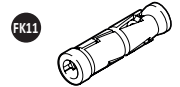

FIXING KIT: 0230-130

Part Ref: 0230-129
M10 x 20mm Pan Head Torx Bolt
Qty: x16



Part Ref: 0230-169
M6 x 70mm Cap Screw
Qty: x3

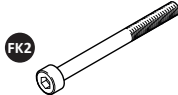

Part Ref: 0230-158
M10 x 14mm Hex Head Set Screw
Qty: x16



Part Ref: 0230-126
4.2 x 9.5 Pan Head Self Tapping Screw
Qty: x52



Part Ref: 0262-16
M8 x 20mm Flanged Button
Head Screw Qty: x25



Part Ref: 0262-17
8.3mm Nylon Flat Washer
Qty: x17



Part Ref: 0262-18
M8 Nylon Nut
Qty: x25



Part Ref: 313-0009Z
No.8 x 13mm Eco Fix
Qty: x12



TOOLS REQUIRED

- Step Ladder
- Spirit Level
- Electric Drill
- Tape Measure
- Pozi Head Screw Driver
- 3 & 5mm Allen Keys
- 13mm Spanner
- Mini Hacksaw

Pergola 3 x 3 Assembly Guide

ASSEMBLY STAGE 1

PRIOR TO ASSEMBLING THE PERGOLA, IS IT IMPORTANT TO IDENTIFY WHICH ORIENTATION BEST SUITS THE END USER, PAYING PARTICULAR ATTENTION TO THE POWER SUPPLY AND GEARBOX POSITIONS.



IMPORTANT:
DO NOT INSTALL THE
PERGOLA IN WINDY
CONDITIONS!



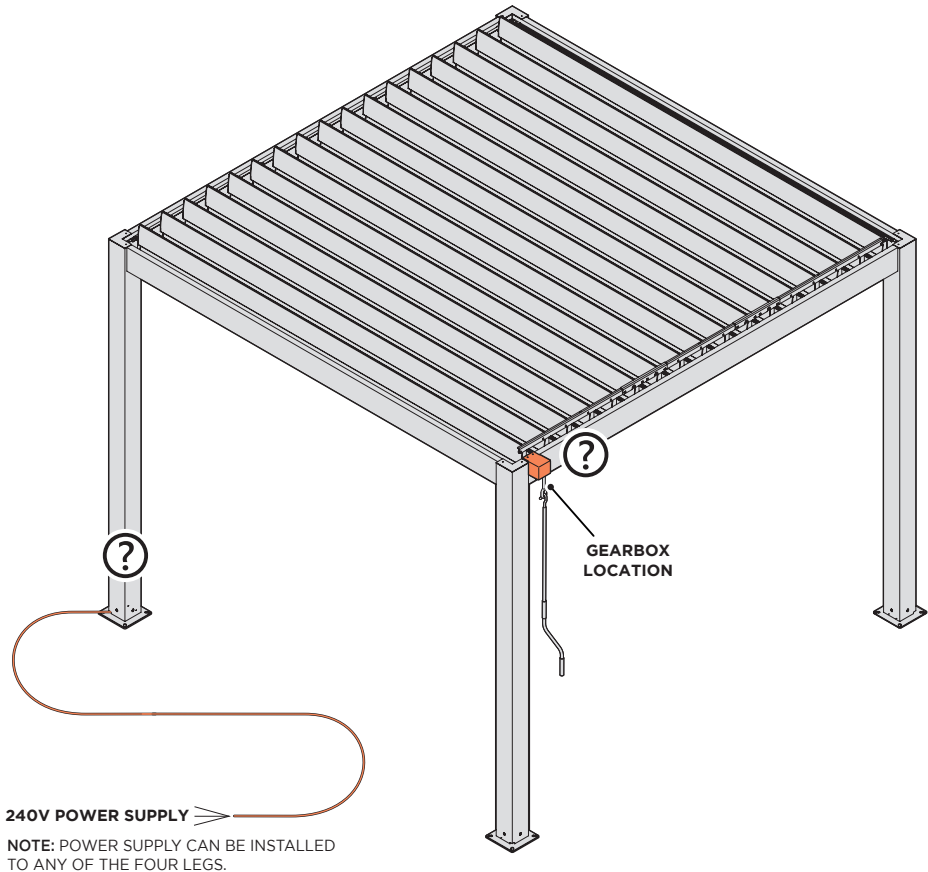



IMPORTANT: CHECK YOU HAVE CORRECTLY PREPARED THE AREA, BEFORE STARTING INSTALLATION. REFER TO TB004 - PERGOLA FOUNDATION GUIDELINES.



Pergola 3 x 3 Assembly Guide

ASSEMBLY STAGE 2

LOCATE AND SECURE PERGOLA LEGS 0230-173 TO GROUND FIXING PLATE 0230-157, ENSURING THE LED CABLE 0230-122-03 IS INSTALLED INTO ONE OF THE PERGOLA'S LEGS.

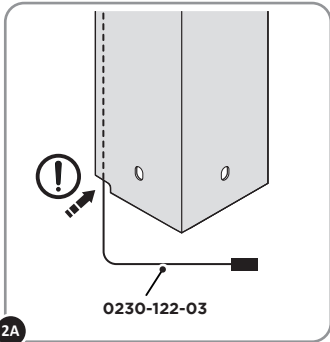
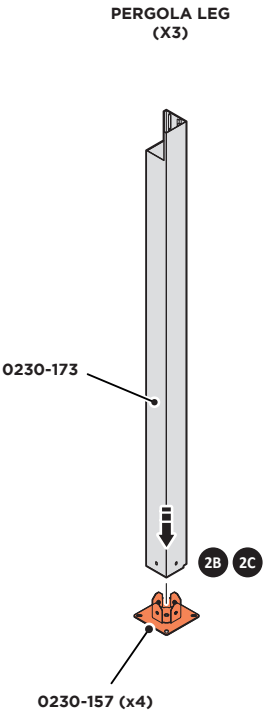
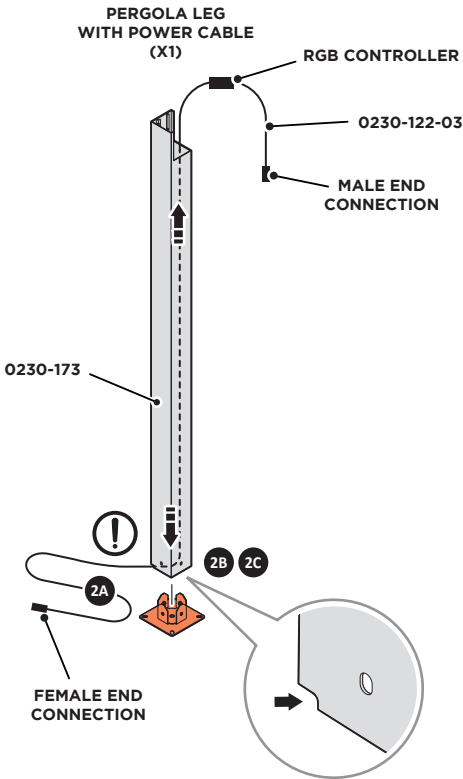

IMPORTANT: ENSURE THE LED CABLE 0230-122-03 EXITS THE PERGOLA LEG 0230-173 VIA THE PROVIDED CUT-OUT.

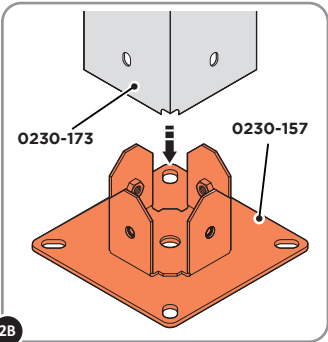

NOTE: TIGHTEN ALL BOLTS, REPEAT PROCESS ON ALL FOUR LEGS.

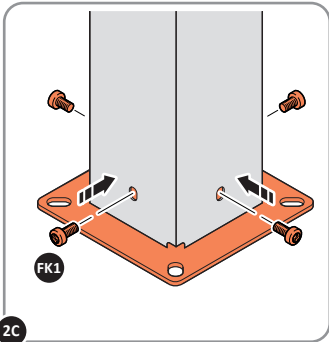

Pergola 3 x 3 Assembly Guide

ASSEMBLY STAGE 3

LOCATE AND SECURE GEARBOX 0230-121, SPACER 0230-167 & FIXING PLATE 0230-119 TO SLOTTED HORIZONTAL BEAM 0230-103.
NOTE: USE A SCRATCH-RESISTANCE SURFACE.

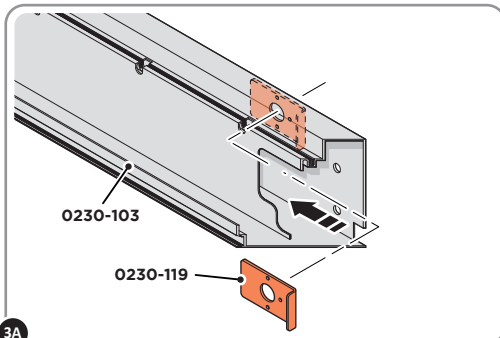
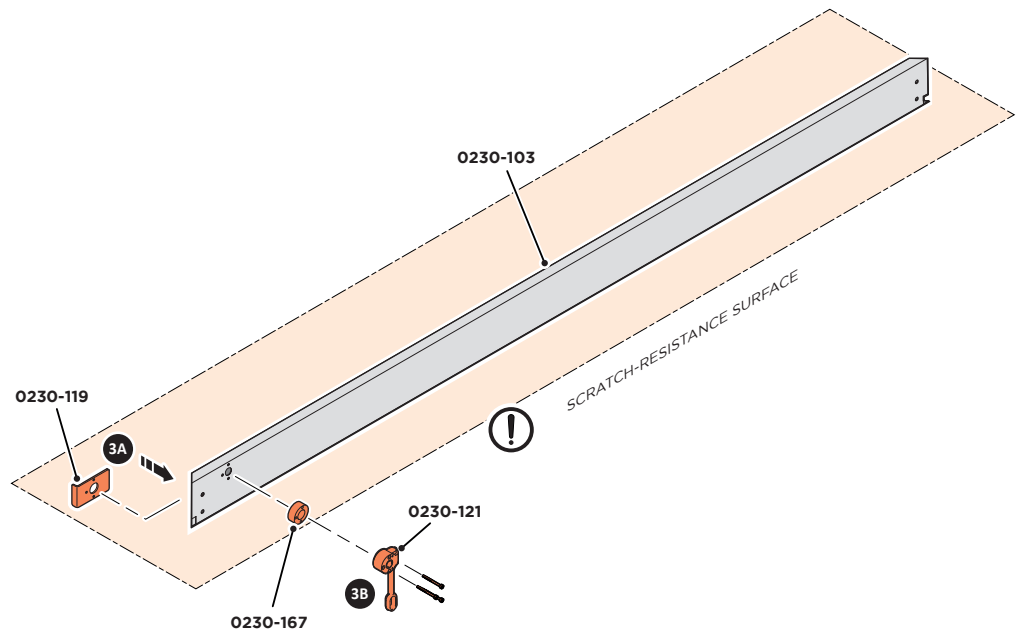

3A LOCATE FIXING PLATE 0230-119 INSIDE SLOTTED HORIZONTAL BEAM 0230-103, ENSURING FIXING HOLES ARE ALIGNED.

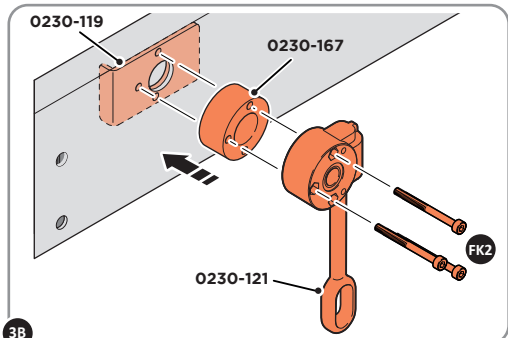

3B LOCATE AND SECURE GEARBOX 0230-121 & SPACER 0230-167 TO FIXING PLATE 0230-119, USING THREE BOLTS, AS SHOWN ABOVE.

ASSEMBLY STAGE 4

LOCATE AND LOOSELY ATTACH FIXING PLATES 0230-149 & 0230-118 TO SLOTTED HORIZONTAL BEAMS.

NOTE: USE A SCRATCH-RESISTANCE SURFACE.

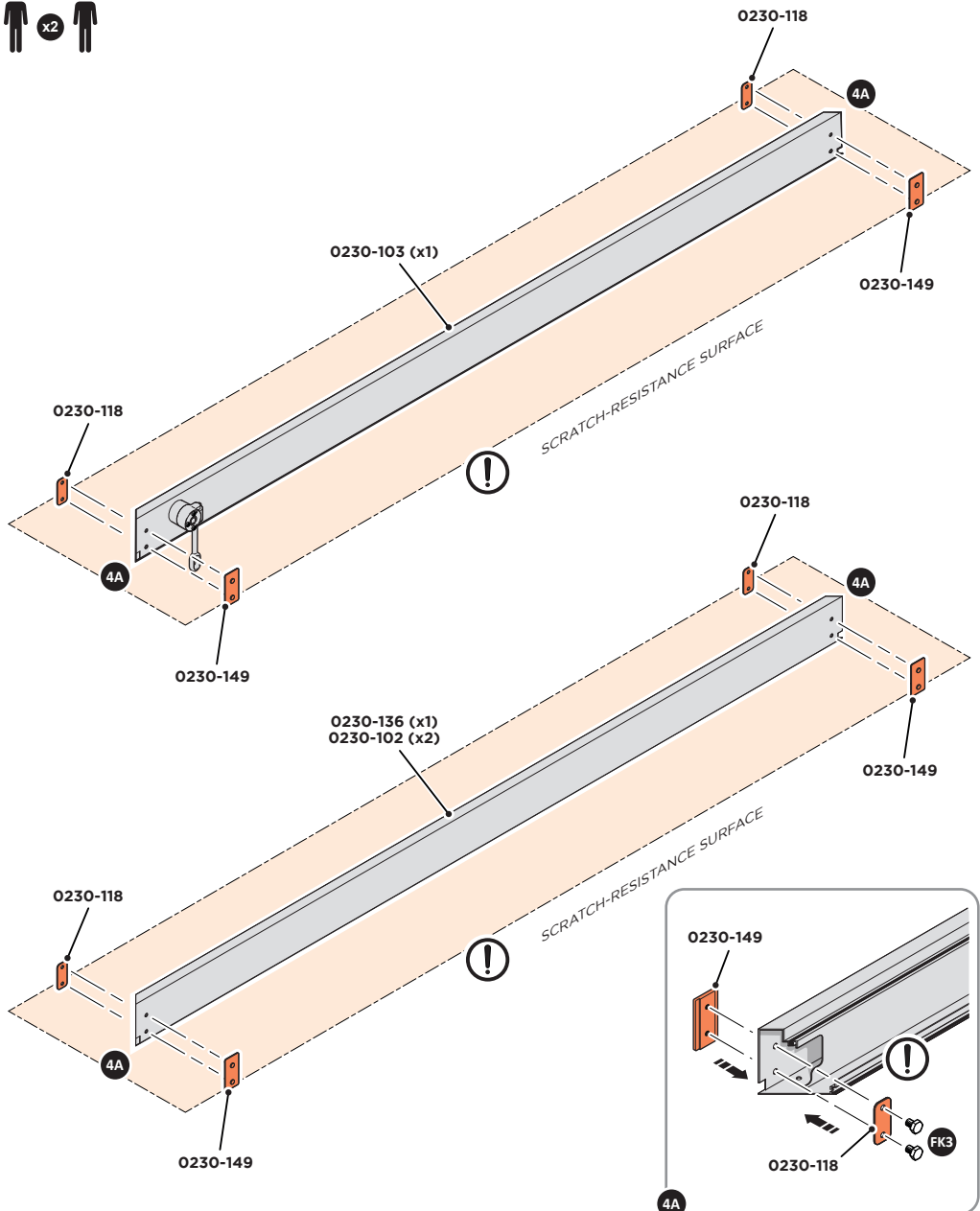

4A

SECURE FIXING PLATES 0230-149 & 0230-118 TO HORIZONTAL BEAMS.

NOTE: LEAVE FIXING SCREWS LOOSE.

Pergola 3 x 3 Assembly Guide

ASSEMBLY STAGE 5

LOCATE SLOTTED HORIZONTAL BEAM 0230-103 INTO PERGOLA LEGS 0230-173.

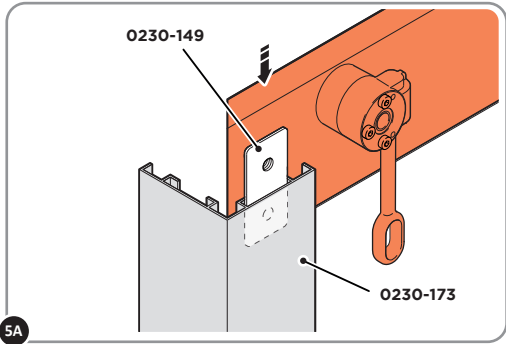
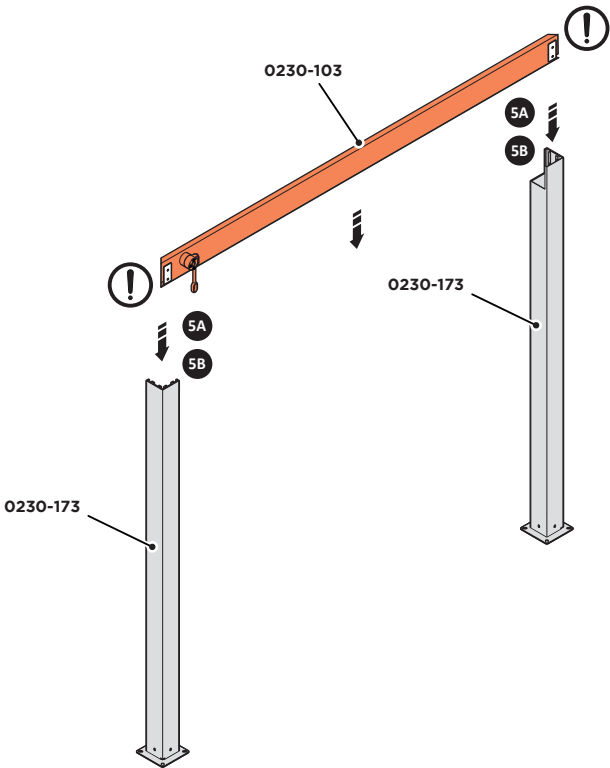

5A ENSURE FIXING PLATE 0230-149, SLOTS INTO TOP OF THE PERGOLA LEG AT BOTH LOCATIONS, AS SHOWN ABOVE.

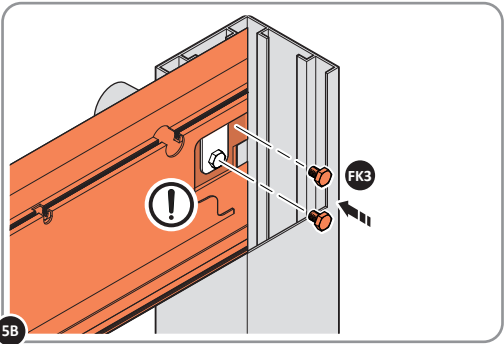

5B NOTE: AT THIS STAGE LEAVE FIXINGS SCREWS (FK3), FINGER TIGHT.

Pergola 3 x 3 Assembly Guide

ASSEMBLY STAGE 6
LOCATE PLAIN HORIZONTAL BEAMS 0230-102 INTO PERGOLA LEGS 0230-173.

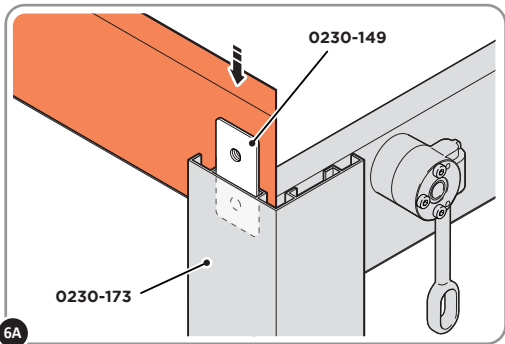
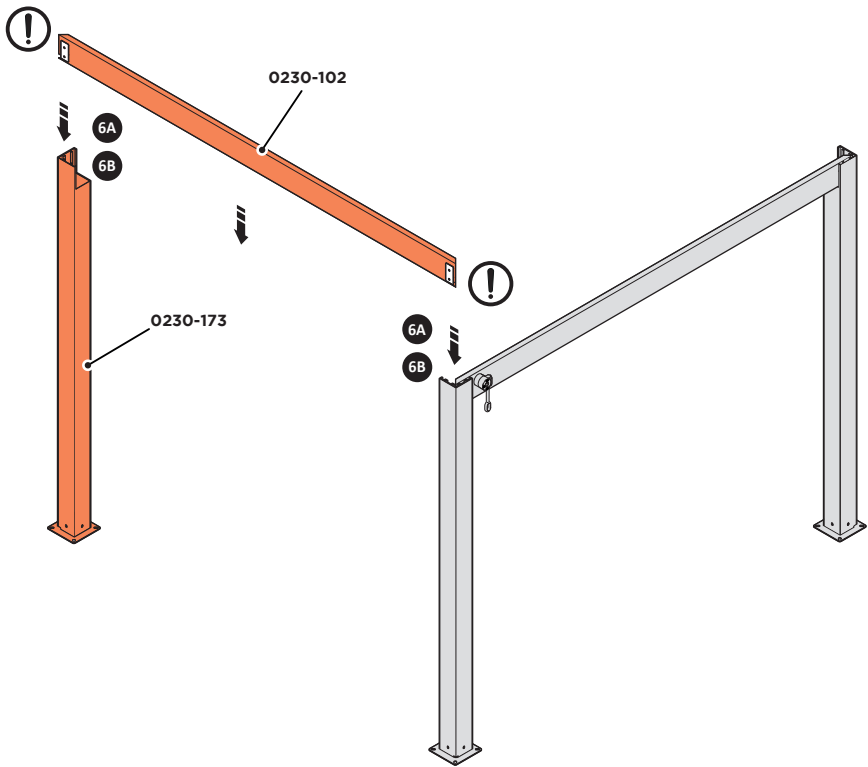

6A
ENSURE FIXING PLATE 0230-149, SLOTS INTO TOP OF THE PERGOLA LEG AT BOTH LOCATIONS, AS SHOWN ABOVE.

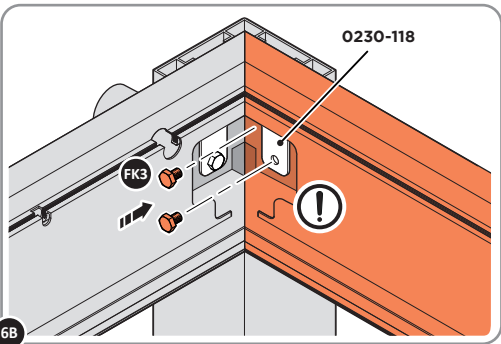

6B
NOTE: AT THIS STAGE LEAVE FIXINGS SCREWS (FK3), FINGER TIGHT.

Pergola 3 x 3 Assembly Guide

ASSEMBLY STAGE 7

LOCATE BRANDED HORIZONTAL BEAM 0230-136 INTO PERGOLA LEGS 0230-173.

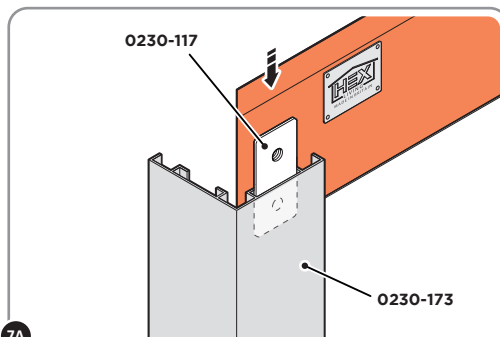
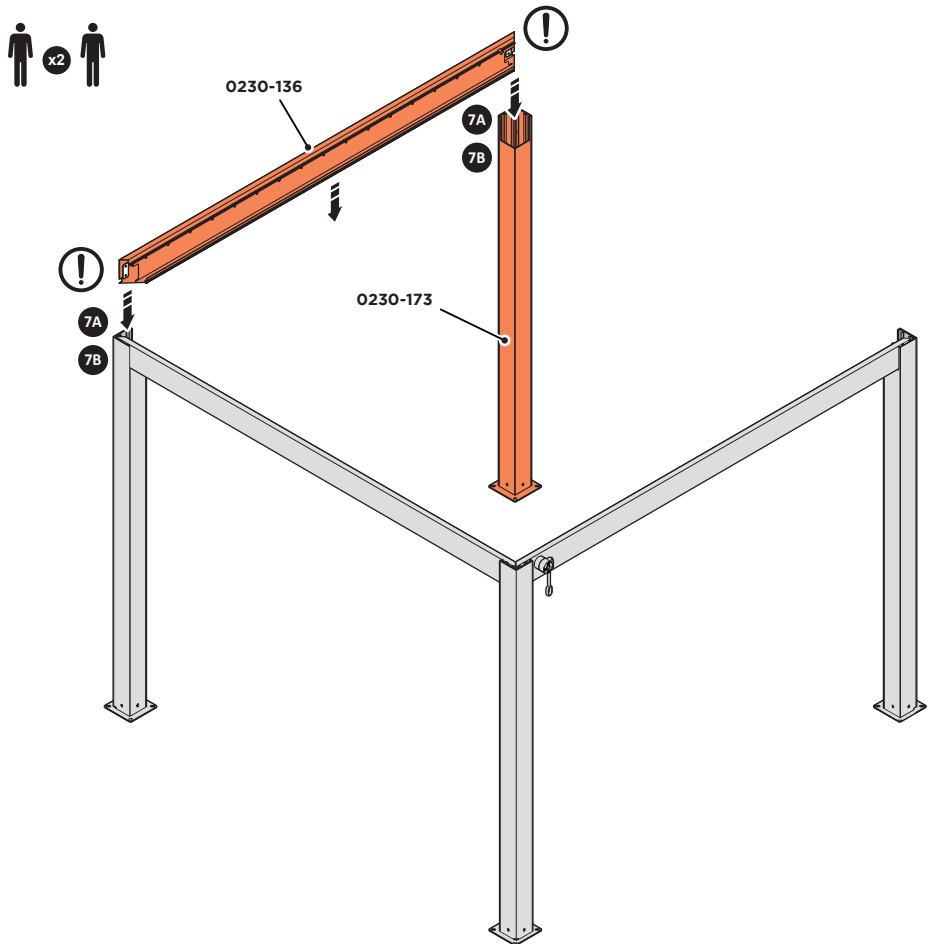

ENSURE FIXING PLATE 0230-149, SLOTS INTO TOP OF THE PERGOLA LEG AT BOTH LOCATIONS, AS SHOWN ABOVE.

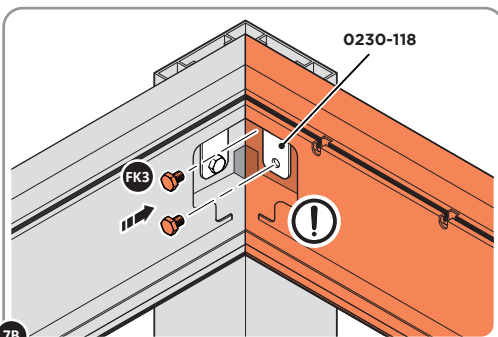

NOTE: AT THIS STAGE LEAVE FIXINGS SCREWS (FK3), FINGER TIGHT.

Pergola 3 x 3 Assembly Guide

ASSEMBLY STAGE 8

LOCATE PLAIN HORIZONTAL BEAM 0230-102 INTO PERGOLA LEGS 0230-173.

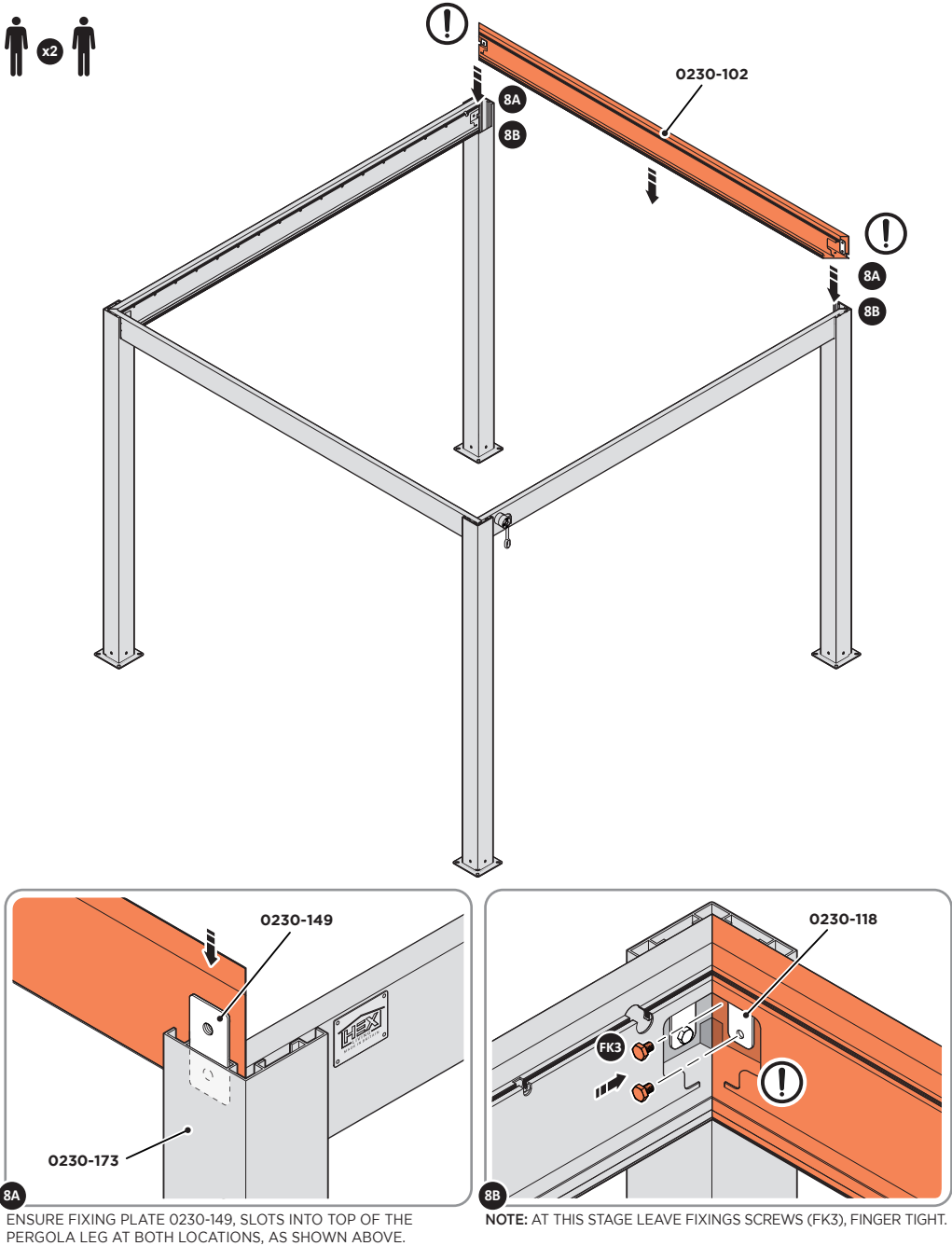

Pergola 3 x 3 Assembly Guide

ASSEMBLY STAGE 9

IMPORTANT: CHECK PERGOLA FRAME FOR SQUARENESS AND THAT THE INNER LEG WIDTH CONFORMS TO THE REFERENCE DIMENSION STATED BELOW.

NOTE: USE FOOT SHIMS IF REQUIRED.

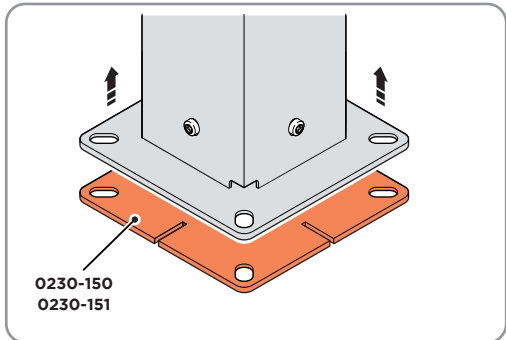
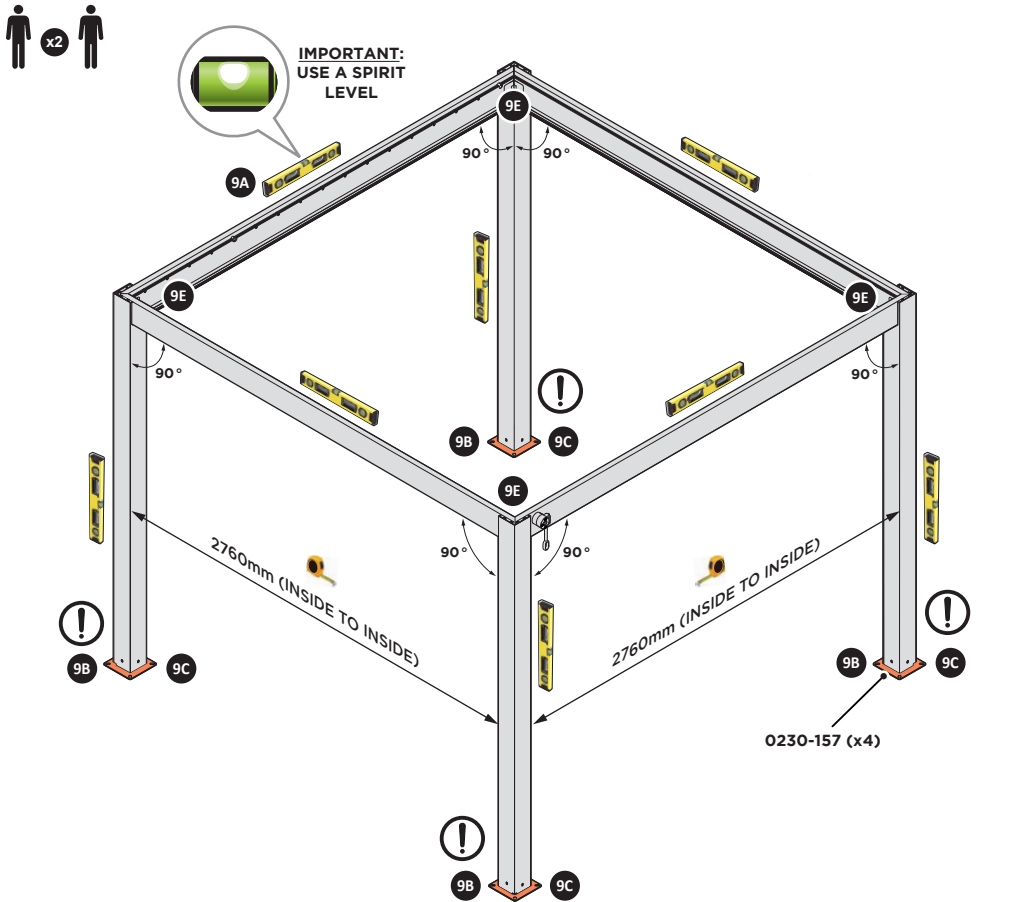

IF THE FOUNDATIONS ARE UNEVEN, SHIM(S) CAN BE ADDED UNDER EACH FOOT AS REQUIRED.

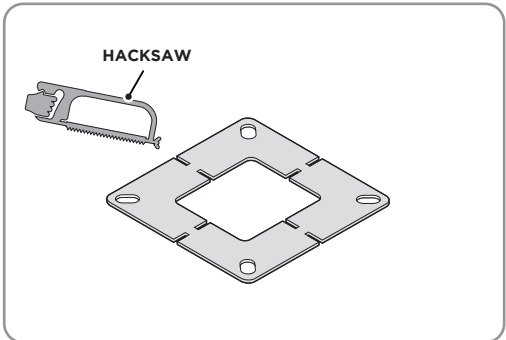

IF REQUIRED, SHIMS CAN BE CUT USING A HACKSAW.

Pergola 3 x 3 Assembly Guide

ASSEMBLY STAGE 9 (CONTINUED)

IMPORTANT: RE-CHECK MEASUREMENTS AND THAT THE FRAME IS LEVEL AND SQUARE, BEFORE DRILLING.

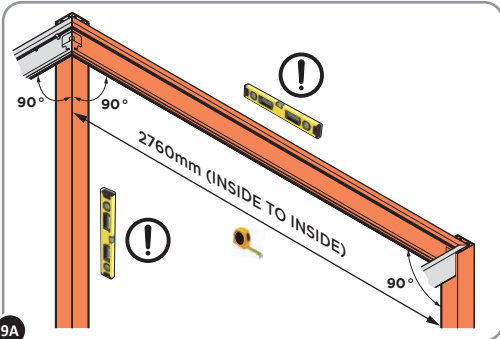

IMPORTANT: CHECK BEAM AND TWO CONNECTING LEGS FOR SQUARENESS. USE A SPIRIT LEVEL. IF ALL IS SQUARE AND MEASUREMENTS ARE CORRECT, YOU'RE READY FOR DRILLING 9B.



DRILL FOUR HOLES FOR EACH LEG, TO ALLOW YOU TO SECURE THE FIXING KIT.

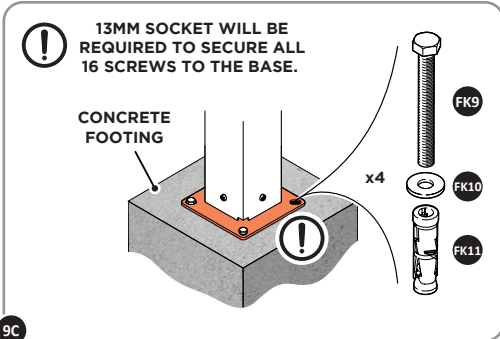

USE THE GROUND FIXING KIT 0230-155 TO SECURE EACH FOOT TO THE GROUND.

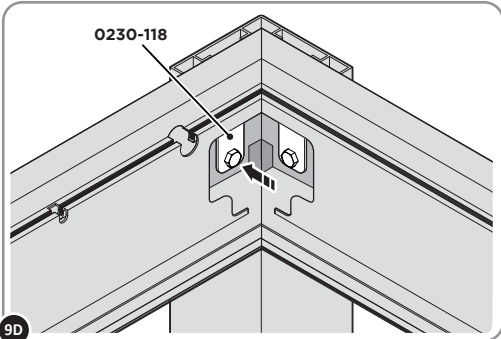

WHEN THE CORNER IS LEVEL AND SQUARE, ENSURE THE CORNER BOLTS ARE TIGHTENED UP.

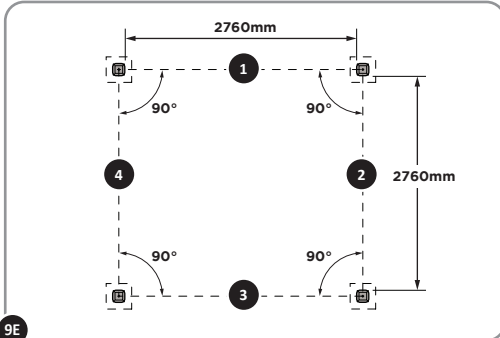

NOW YOU HAVE ONE SIDE SECURED TO THE GROUND, REPEAT THE SAME PROCESS FOR EACH OF THE OTHER SIDES.



Pergola 3 x 3 Assembly Guide

ASSEMBLY STAGE 10

LOCATE AND SECURE BEARING 0230-113 TO DRIVING LOUVER 0230-174. SECURE DRIVING BUSH 0230-134 TO BEAM 0230-103. INSERT DRIVING PIN 0230-177 THROUGH GEARBOX INTO DRIVING LOUVER 0230-174. SECURE NON-DRIVING END BEARING 020-113 TO BEAM 0230-136..

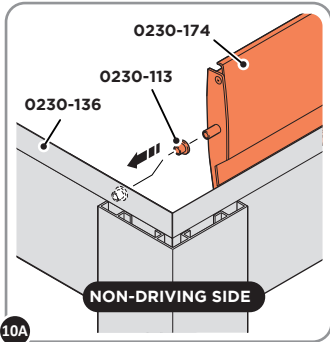
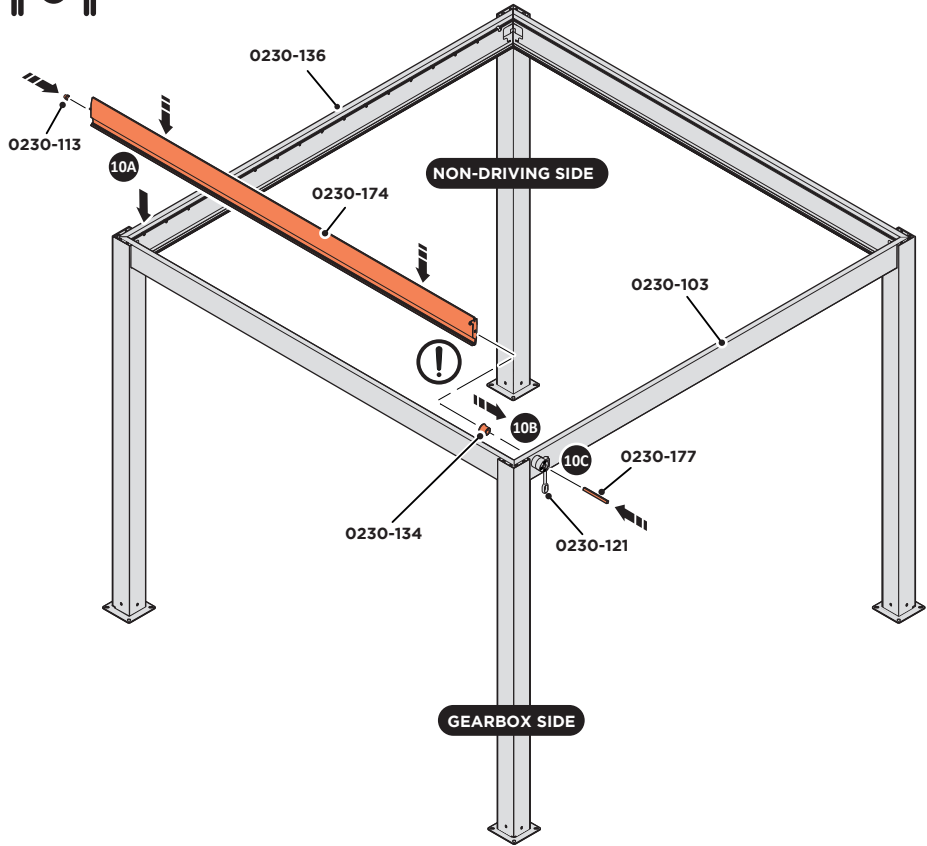

10A
LOCATE AND SECURE LOUVER BEARING 0230-113 ONTO LOUVER 0230-174, SECURE TO BEAM 0230-136 ON NON-DRIVE SIDE.

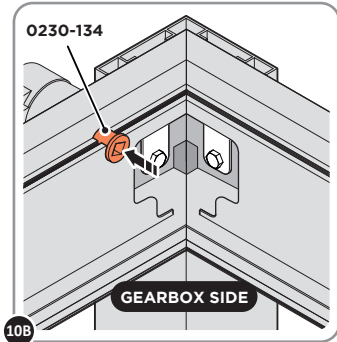

10B
LOCATE AND SECURE DRIVING BUSH 0230-134 TO BEAM 0230-103, AS SHOWN ABOVE.

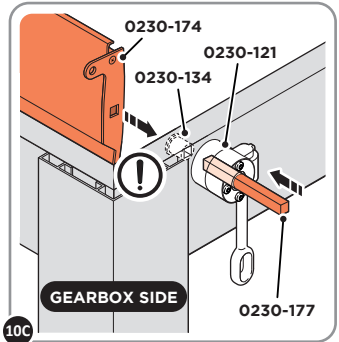

10C
LOCATE AND PUSH DRIVING PIN 0230-177 THROUGH GEARBOX AND BUSH 0230-134, SECURE LOUVER 0230-174 TO DRIVING PIN.

Pergola 3 x 3 Assembly Guide

ASSEMBLY STAGE 11

LOCATE AND SECURE LOUVERS 0230-171 USING BEARINGS 0230-113 AT LOCATIONS INDICATED. FINAL LOUVER USE BEARINGS 0230-116 & 0230-113.

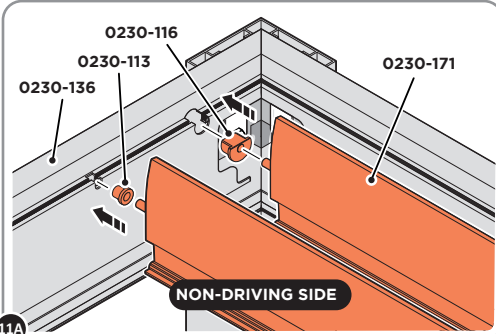
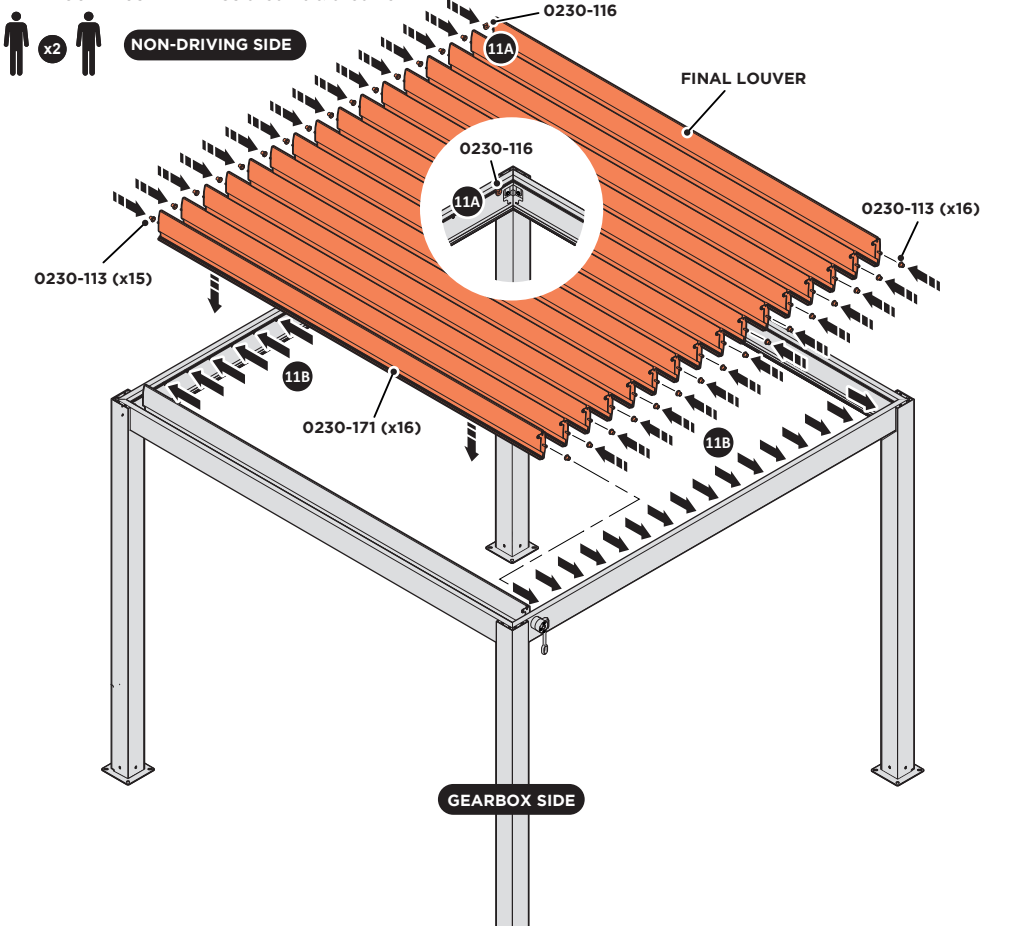

SECURE LOUVER BEARING 0230-116, ONTO HORIZONTAL BEAM 0230-136. INSERT FINAL LOUVER 0230-171 INTO BEARING, AS SHOWN ABOVE.

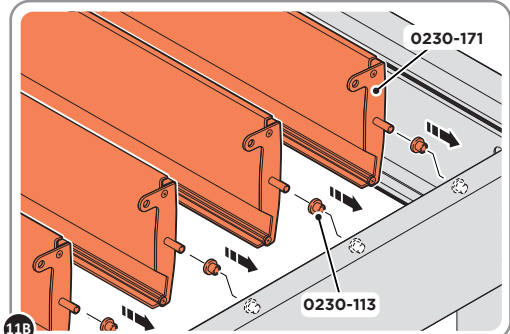

SECURE LOUVER BEARING 0230-113, LOCATED ON THE DRIVE SIDE TO BEAM AS SHOWN ABOVE.

Pergola 3 x 3 Assembly Guide

ASSEMBLY STAGE 12

LOCATE AND SECURE LOUVER STRIPS 0230-165 AND 0230-166 TO HORIZONTAL BEAMS 0230-103 & 0230-136.

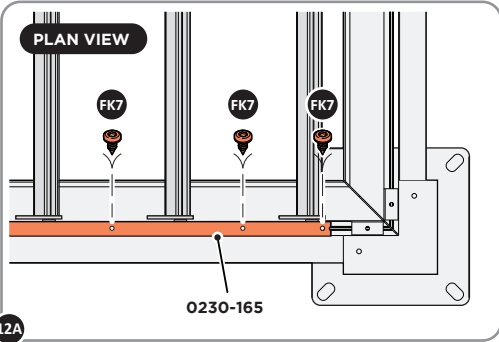
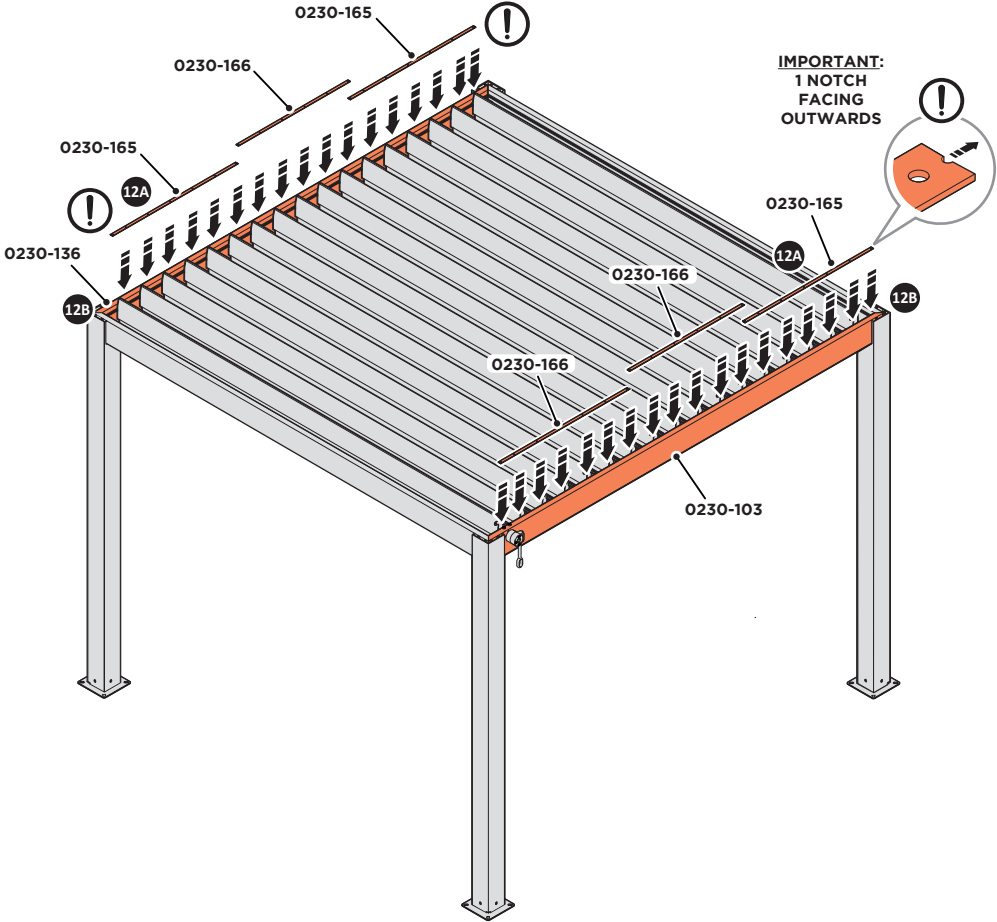

SECURE LOUVER CLAMPS TO HORIZONTAL BEAM USING SELF TAPPING SCREWS (FK7). MAKE SURE YOU ALIGN HOLES EQUALLY BETWEEN LOUVERS, AS SHOWN ABOVE.

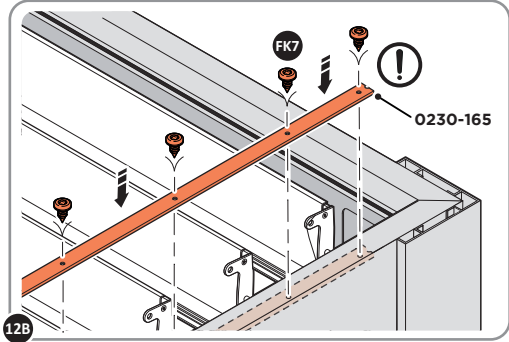

NOTE: MAKE SURE LOUVER CLAMP 0230-165 IS POSITIONED WITH THE 1 NOTCH FACING OUTWARDS, AS SHOWN ABOVE.

Pergola 3 x 3 Assembly Guide

ASSEMBLY STAGE 13

LOCATE AND LOOSELY ATTACH LOUVER LINK ARMS 0230-161,162 & 163, TO ALL LOUVERS AT LOCATIONS INDICATED BELOW.

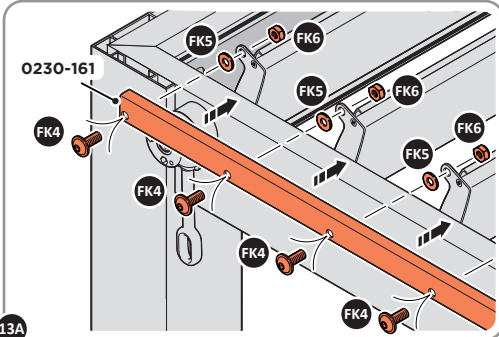
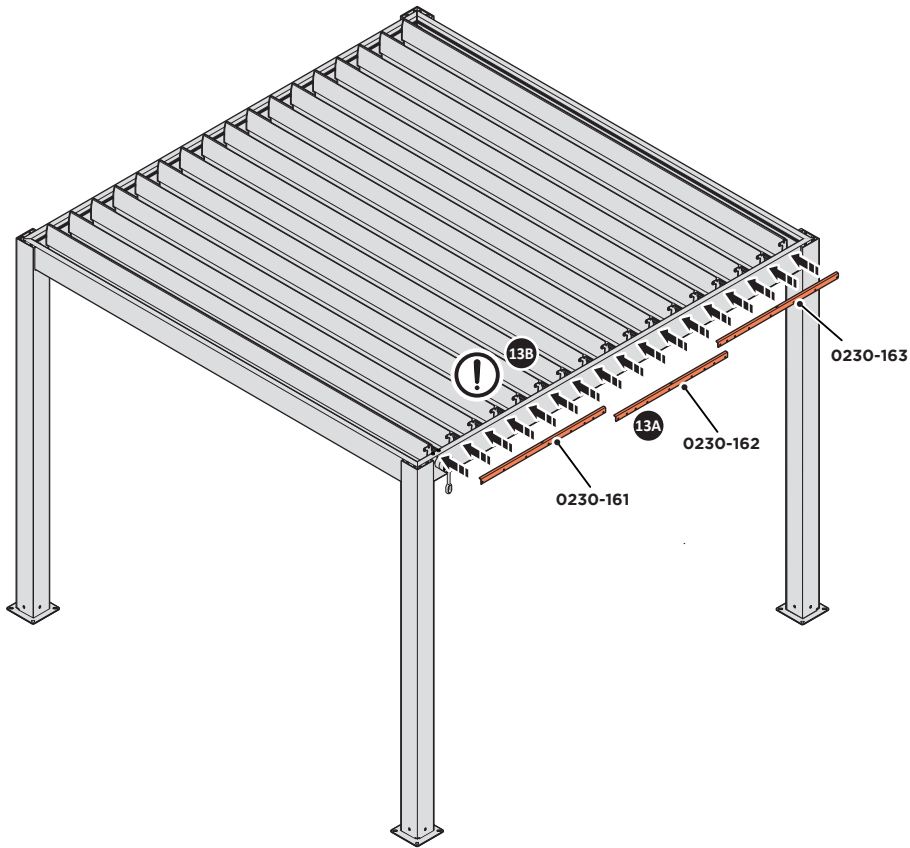

DURING ASSEMBLY ENSURE THE FRICTION WASHERS (FK5) ARE LOCATED BETWEEN THE LINK ARM AND LOUVERS. LEAVE FIXINGS FINGER TIGHT.

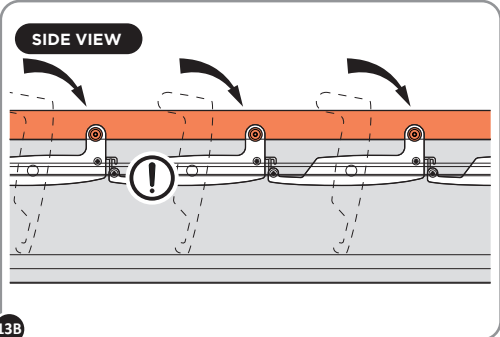

WITH THE LINK ARMS CONNECTED, ALLOW THE LOUVERS TO REST IN THEIR CLOSED POSITION.

ASSEMBLY STAGE 13 (CONTINUED)

LOCATE AND SECURE 0260-164 LINK ARM CONNECTORS TO LOUVERS LINK ARMS.
TOOLS REQUIRED: 13MM SPANNER AND 5MM ALLEN KEY.

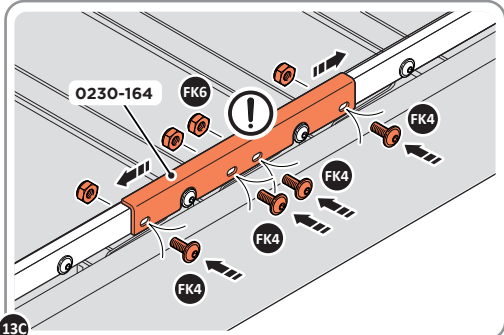
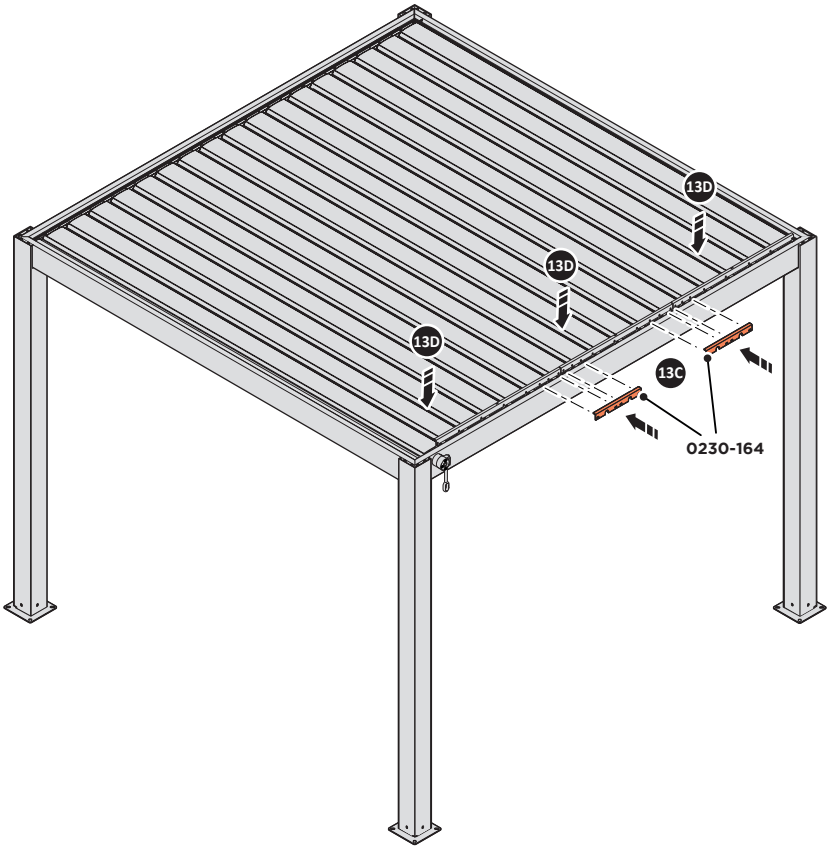

NOTE: SECURE LINK ARM CONNECTORS WITH FIXINGS FK4 & FK6 AND FULLY TIGHTEN.

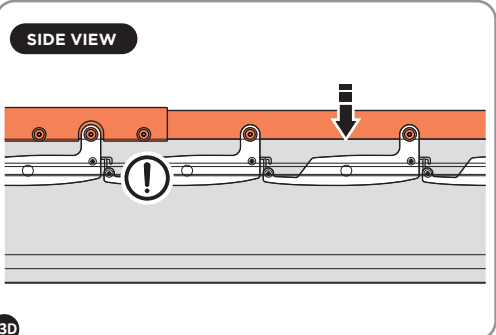

TO ENSURE THE LOUVERS ARE FULLY CLOSED, APPLY A SMALL AMOUNT OF DOWNWARDS PRESSURE BEFORE TIGHTENING UP ALL THE FIXINGS.
NOTE: ENSURING THEY CAN STILL FREELY ROTATE AFTERWARDS.

Pergola 3 x 3 Assembly Guide

ASSEMBLY STAGE 14

LOCATE AND SECURE GEARBOX COVER 0230-120 TO TOP OF PERGOLA BEAM 0230-120.
LOCATE AND ATTACH CRANK HANDLE 0230-123 TO GEARBOX 0230-121.



IMPORTANT: ENSURE ALL LOUVERS
MOVE FREELY, WHEN ROTATING
CRANK HANDLE. SMALL ADJUSTMENT TO
THE LOUVER FIXINGS MAY BE REQUIRED,
REFER TO PREVIOUS ADVICE '13D'

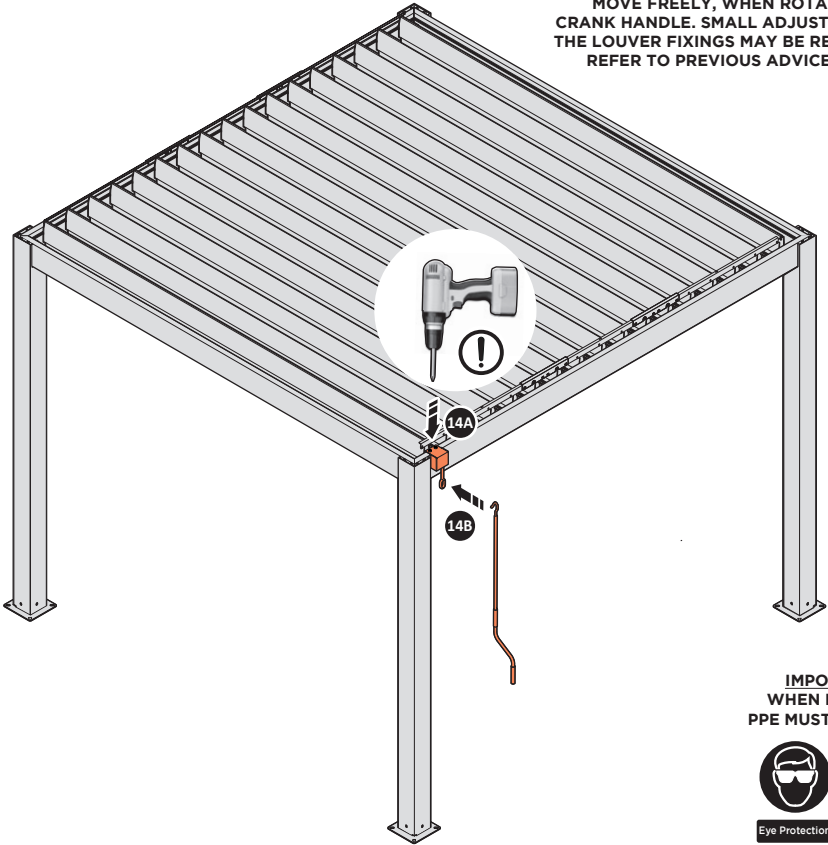

IMPORTANT:
WHEN DRILLING,
PPE MUST BE WORN!



Eye Protection

Gloves

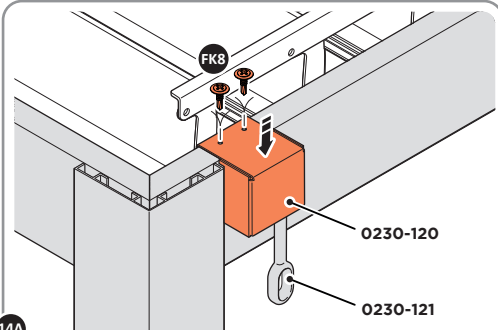

14A LOCATE GEARBOX COVER 0230-120 AND SECURE TO TOP OF PERGOLA BEAM USING X2 ECO FIX SCREWS (FK8).

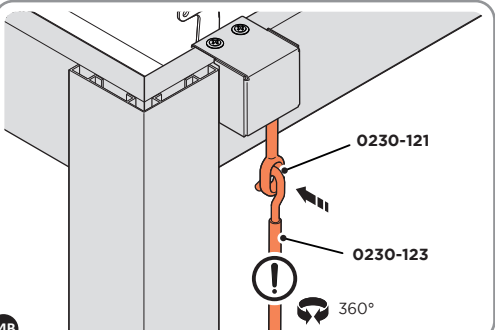

14B ATTACH CRANK HANDLE 0230-123 TO GEARBOX 0230-121.
NOTE: CHECK CRANK HANDLE ROTATES 360°, WHILST OPERATING LOUVERS.

Pergola 3 x 3 Assembly Guide

ASSEMBLY STAGE 15

LOCATE AND SECURE CORNER POST CAPS 0230-110 TO TOPS OF PERGOLA LEGS 0230-100.

NOTE: CORNER SECTIONS SHOULD BE MADE WATERTIGHT, USING SEALANT 0239-131.

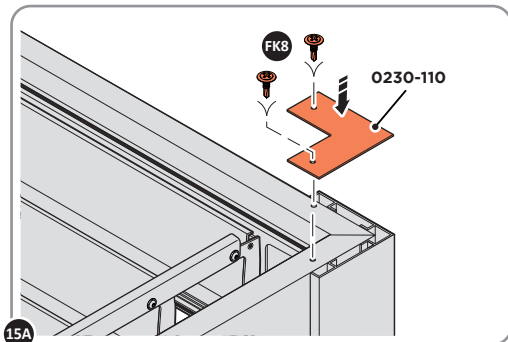
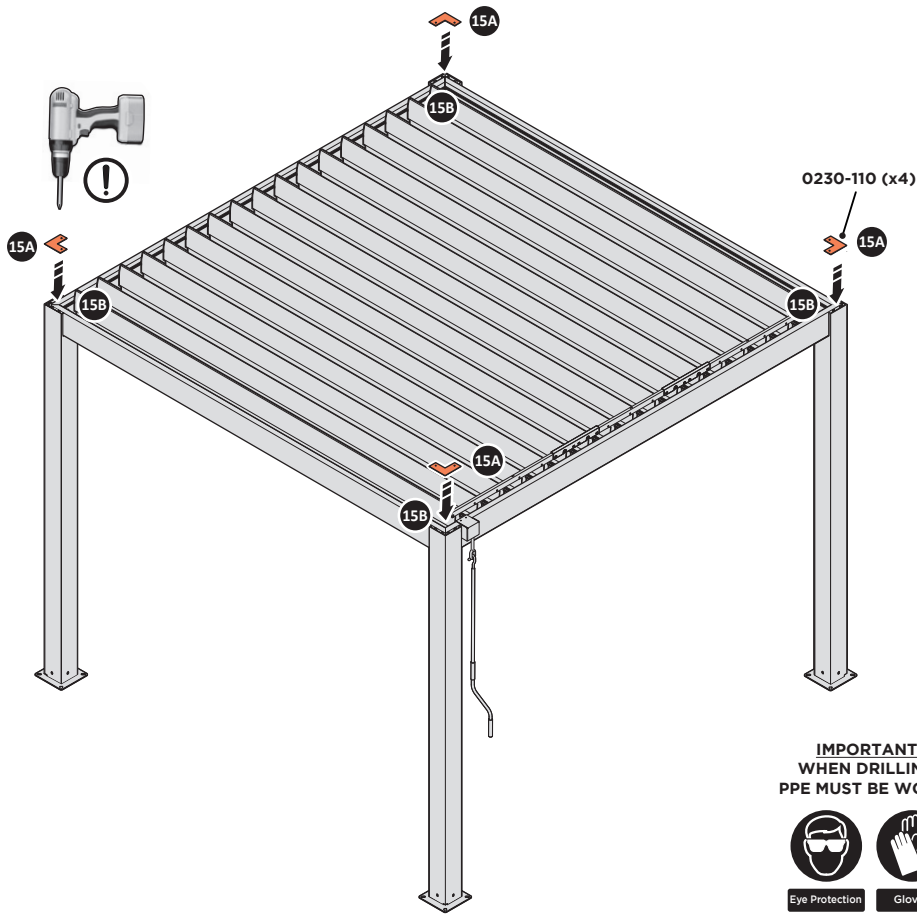

LOCATE CORNER POST CAPS 0230-110 AND SECURE TO PERGOLA LEGS USING (X2) ECO FIX SCREWS (FK8).

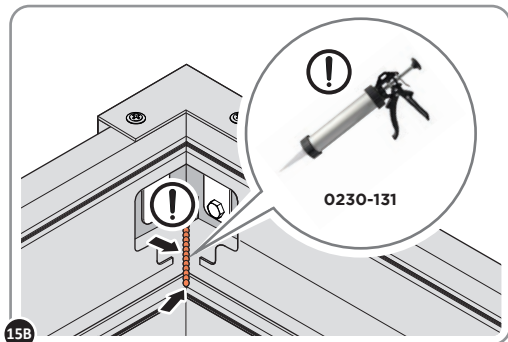

CORNER SECTIONS SHOULD BE MADE WATERTIGHT WITH SEALANT PROVIDED.

Pergola 3 x 3 Assembly Guide

ASSEMBLY STAGE 16

LOCATE AND SECURE THE LED LIGHTS 0230-122-01 AND LED DIFFUSERS STRIPS 230-122-02 INTO THE LIGHTING CHANNEL ALONG THE HORIZONTAL BEAMS.

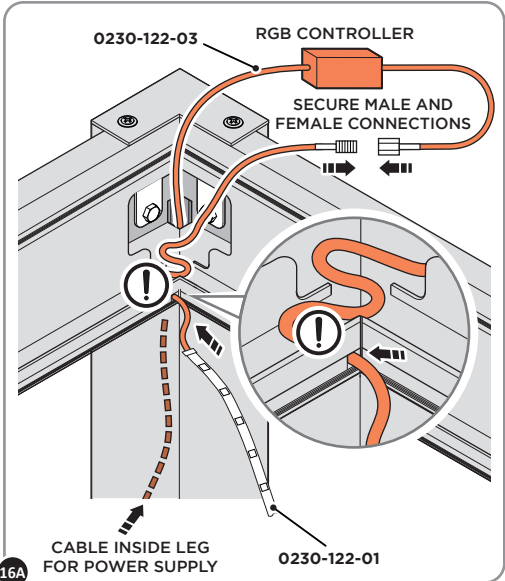

16A LOCATE RGB CONTROLLER 0230-122-03 AND CONNECT TO LED LIGHT CONNECTOR 0230-122-01. POSITION CABLE THROUGH GAP, AS SHOWN ABOVE.

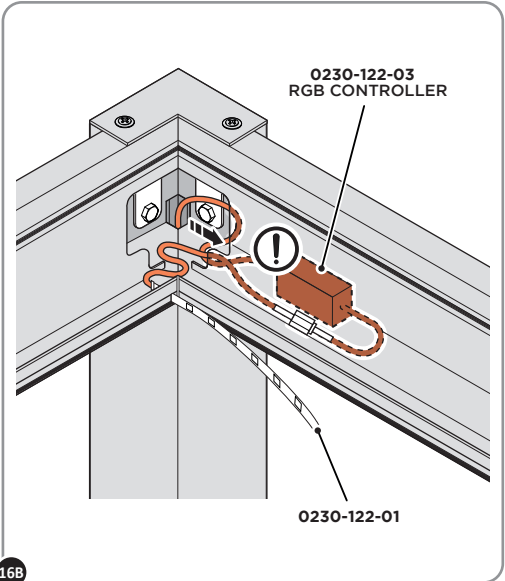

16B POSITION RGB CONTROLLER AND CABLE INSIDE BEAM AS SHOWN ABOVE.

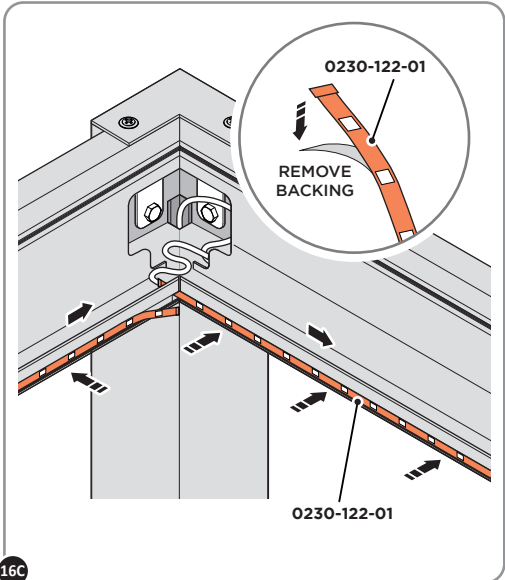

16C LOCATION LED STRIP 0230-122-01, PEEL-OFF PROTECTIVE ADHESIVE BACKING AND ADHERE LED LIGHTS TO BEAM AS SHOWN ABOVE. THE LED STRIP FITS IN THE GROVE ALL ROUND THE FOUR SIDES.

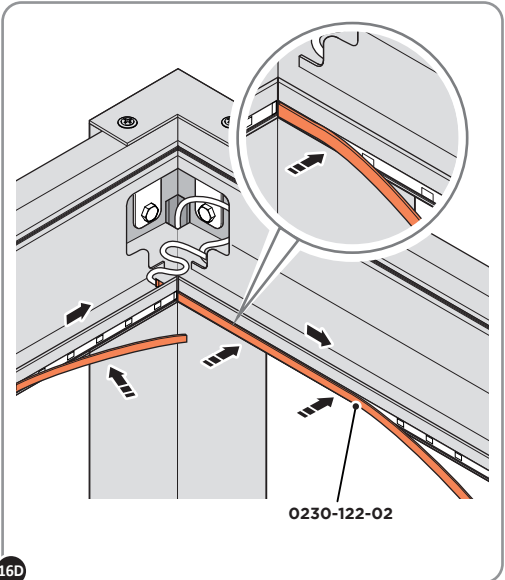

16D MEASURE INSIDE LEG DIMENSIONS AND CUT LED DIFFUSERS (x4) 0230-122-02 TO LENGTH. PUSH AND CLICK INTO THE CHANNELS.

Pergola 3 x 3 Assembly Guide

ASSEMBLY STAGE 17

LOCATE AND SECURE CORNER COVER PLATES 0230-135 AS SHOWN BELOW.

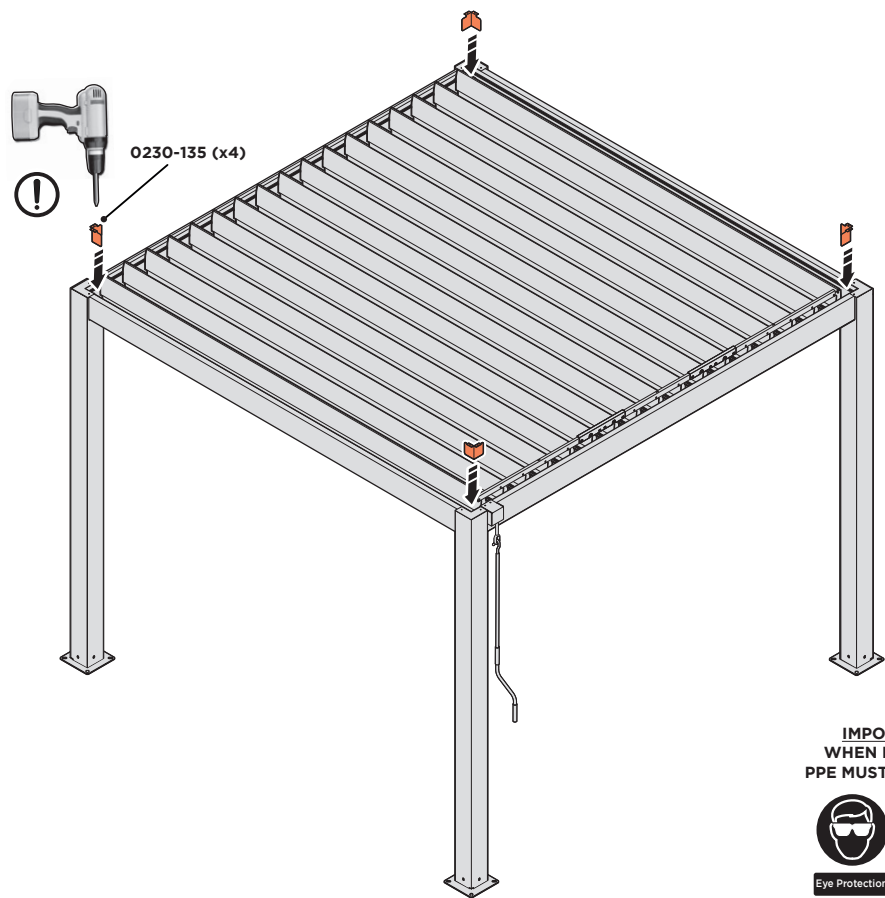

**IMPORTANT:
WHEN DRILLING,
PPE MUST BE WORN!**



Eye Protection

Gloves

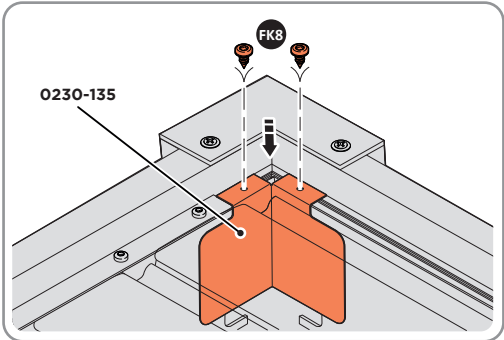

LOCATE CORNER COVER PLATE 0230-135 AND SECURE TO HORIZONTAL BEAM USING SELF TAPPING SCREWS (FK8).

Pergola 3 x 3 Assembly Guide

ASSEMBLY STAGE 18

LOCATE AND SECURE LED POWER CABLE 0230-122-05, USE OPTIONAL EXTENSION CABLE 0230-122-04, IF REQUIRED.

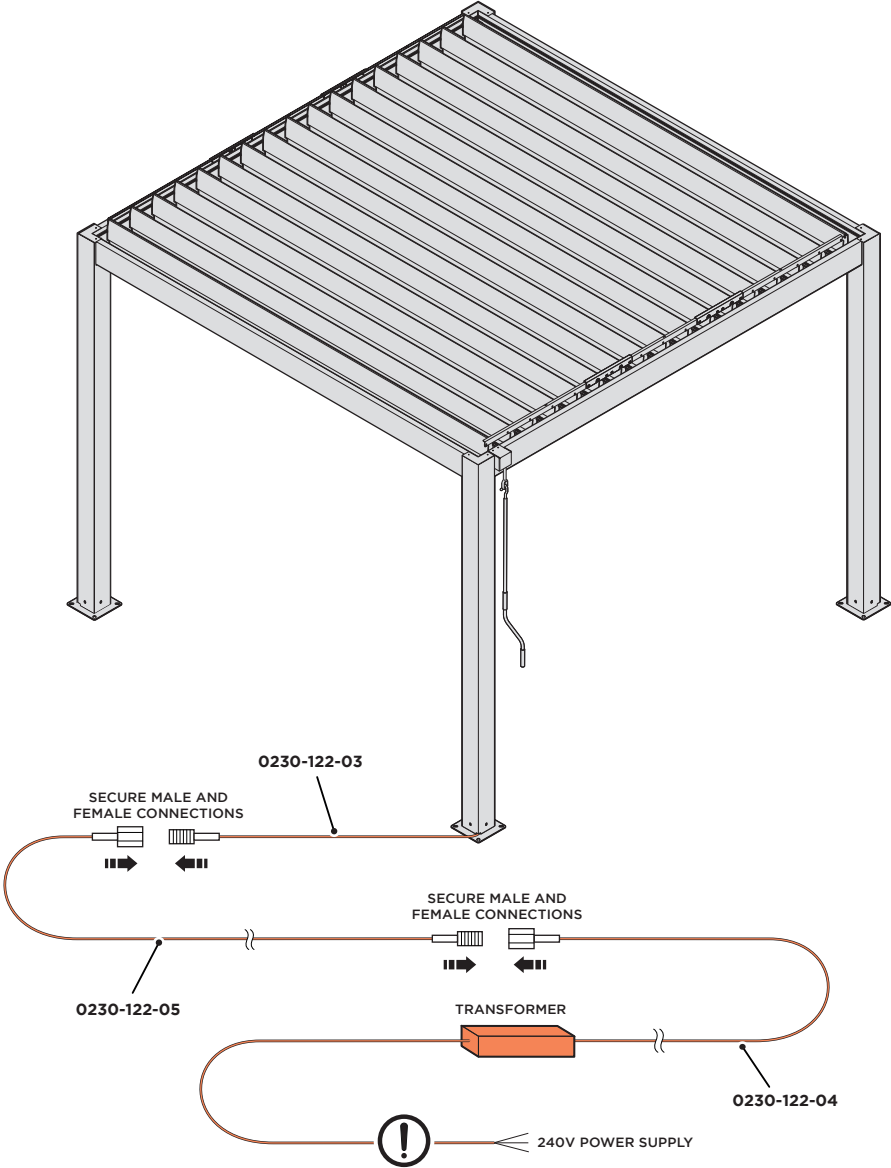

IMPORTANT: USE A QUALIFIED ELECTRICIAN WHEN CONNECTING THE LED LIGHTING TO A MAINS SUPPLY.

NOTES

Caring for your HEX Living product

Your **HEX Living product** is designed to stand the test of time, which is why we're happy to offer a **lifetime warranty** on our products. With zero maintenance required, simply assemble your HEX Living product, and enjoy putting it to great use in your garden.

Periodically, you might want to give your product a clean, these simple care tips are not essential to the performance of your product:

- Remove surface dirt with plain water using a jet wash or sponge, the coating on our products will ensure dirt or mud simply wipes away.
- If you've purchased a HEX Living metal pergola, periodically clear the roof of fallen leaves.
- If your product has blinds, regular cleaning and remove of garden debris as you would on your home.

Ensure you have registered your HEX Living product

Using the unique serial number found on the cover of this document, please visit www.hexliving.co.uk to register your product and access the HEX Living lifetime warranty and video instructions.

Customer Service: +44 (0) 1889 272 056



Doc Ref: 699-0834A2_Rev.B