

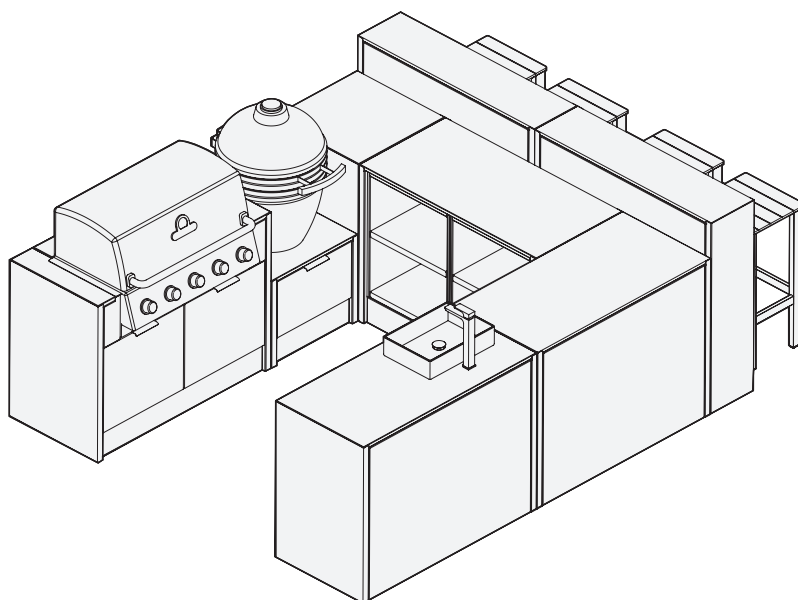

Buckley Outdoor Kitchen Assembly Guide Manual



Customer Service: +44 (0) 1889 272 056

IMPORTANT: PLEASE REGISTER YOUR HEX LIVING PRODUCT AFTER ASSEMBLY

Using the unique serial number, simply register your product at **www.hexliving.co.uk** or use the QR code above to access the HEX Living lifetime warranty and online support.

Affix Serial Number
HERE

CONTENTS

1. PART LIST AND TOOLS REQUIRED	3
2. INTRODUCTION AND ROUTINE CLEANING	4
3. STEP-BY- STEP ASSEMBLY GUIDELINES	4
4. SITE PREPARATION AND UTILITY ACCESS HOLES	4
5. LEVELLING A KITCKEN CABINET	5
6. JOINING TWO KITCHEN CABINETS	7
7. WORKTOP INSTALLATION	10
8. SHELF INSTALLATION	11
9. CABINET DOOR INSTALLATION	12
10. BAR UNIT INSTALLATION	13
11. BASIN UNIT INSTALLATION	15
12. COOLER UNIT INSTALLATION	17
13. GAS BURNER UNIT INSTALLATION	18
14. KAMADO UNIT INSTALLATION	19
15. BACK PANEL INSTALLATION	20
16. BRAND PLATE INSTALLATION	22
17. FITTING A KITCHEN COVER (ACCESSORY)	23
18. LIMITED WARRANTY	24



PRIOR TO ASSEMBLY:

PLEASE READ THIS GUIDE THOROUGHLY, CHECK THAT YOU HAVE ALL THE CORRECT COMPONENTS. INSURE ALL SERVICES (GAS, WATER, ELECTRICS) HAVE BEEN INSTALLED PRIOR TO YOUR KITCHEN INSTALLATION?

IF YOU ARE INSTALLING A GAS BBQ, ENSURE THAT THE AREA YOU HAVE CHOSEN IS WELL VENTILATED, AND A SAFE DISTANCE FROM ANY FLAMMABLE MATERIALS FOR EXAMPLE LOW HANGING TREES OR BUSHES.

IF FOR ANY REASON YOU NEED ASSISTANCE, CONTACT OUR CUSTOMER SERVICE TEAM ON +44 (0) 1889 272 056.

1. PARTS LIST AND TOOLS REQUIRED

FIX KIT 0270-FX

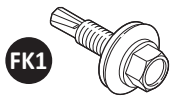

PART REF: 0270-196
SELF TAPPING SCREW
QTY: X10



PART REF: 0243-114
M6 SERRATED FLANGE NUT
QTY: X10



PART REF: 0270-325
M6 SERRATED FLANGE BOLT
QTY: X10

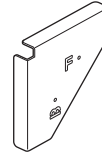

PART REF: 0270-326
DRILL JIG



PART REF: 0203-53
BRAND PLATE, QTY: X1



PART REF: 0205-100
SNAP RIVETS, QTY: X4

TOOLS REQUIRED



4MM AND 5MM ALLEN KEYS



MARKER



POZI HEAD SCREW DRIVER

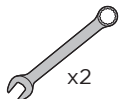

10MM SPANNER



RUBBER Mallet



SPIRIT LEVEL



TAPE MEASURE



POWER DRILL



SEALANT & GUN



HACKSAW

TWO PERSON ASSEMBLY

THIS WELL ENGINEERED OUTDOOR KITCHEN REQUIRES 2 PEOPLE TO ASSEMBLE, TYPICAL TIME TO COMPLETE A MID. SIZE ARRANGEMENT 4-5 HOURS.



PERSONAL PROTECTION EQUIPMENT

WE ADVISE APPROPRIATE PERSONAL PROTECTIVE EQUIPMENT IS WORN DURING ASSEMBLY INCLUDING EYE PROTECTION AND GLOVES.



Eye Protection



Gloves

2. INTRODUCTION AND ROUTINE CLEANING

LIKE ALL OUR OUTDOOR PRODUCTS, YOUR BUCKLEY KITCHEN HAS TO PREVAIL AGAINST FLUCTUATING WEATHER CONDITIONS. WITH THIS IN MIND, CARING FOR YOUR OUTDOOR KITCHEN IS EXTREMELY IMPORTANT. REST IN CONFIDENCE, OUR OUTDOOR KITCHENS HAVE BEEN ENGINEERED USING ONLY THE BEST QUALITY MATERIALS, READY FOR WHATEVER THE BRITISH WEATHER THROWS AT YOU. HOWEVER, TO PROLONG THE LIFESPAN OF YOUR OUTDOOR KITCHEN, REGULAR CLEANING AND PERIODIC MAINTENANCE IS RECOMMENDED, TO ENSURE THAT YOUR PRODUCT IS ALWAYS LOOKING AT ITS BEST.

ROUTINE CLEANING:

FOR PORCELAIN WORK SURFACES AND METAL WORK, A SIMPLE WIPE-DOWN WITH A SPONGE, WARM WATER AND A MILD DETERGENT (SOAPY LIQUID) WILL BE SUFFICIENT BEFORE EVERY USE. ANY SPILLS SUCH AS, FOOD OR LIQUIDS SHOULD BE REMOVED SPEEDILY TO AVOID ANY LONG-TERM STAINING. PLEASE CONTACT OUR CUSTOMER SERVICE TEAM FOR ANY REPLACEMENT PARTS. **+44 (0) 1889 272 056.**

3. STEP-BY-STEP ASSEMBLY GUIDELINES

THIS MANUAL IS INTENDED TO PROVIDE STEP-BY-STEP INSTRUCTIONS ON HOW TO ASSEMBLE YOUR NEW OUTDOOR KITCHEN. IT IS IMPORTANT THAT PRIOR TO STARTING, YOU HAVE THE CORRECT TOOLS REFERENCED IN THIS DOCUMENT AND THAT THE STEPS ARE FOLLOWED TO ENSURE A SUCCESSFUL INSTALLATION. **NOTE:** SOME DRILLING WILL BE REQUIRED!

OUR OUTDOOR KITCHENS HAVE BEEN DESIGNED TO ENABLE BOTH DIY ENTHUSIASTS AND PROFESSIONALS ALIKE TO INSTALL OUR PRODUCT WITHOUT THE NEED OF ANY SPECIALISED TOOLS. NEED A HELPING HAND? SIT BACK, RELAX, AND LET OUR EXPERT INSTALLATION TEAM TAKE CARE OF EVERYTHING. FOR MORE INFORMATION OR ASSISTANCE PLEASE CONTACT OUR CUSTOMER SERVICE TEAM ON **+44 (0) 1889 272 056.**



IMPORTANT: ALL PLUMBING, MAINS GAS AND ELECTRICAL CONNECTIONS MUST BE CARRIED OUT BY A CERTIFIED PROFESSIONAL. OUR INSTALLATION TEAM DO NOT PROVIDE THESE SERVICES, SO PLEASE ENSURE APPROPRIATE ARRANGEMENTS HAVE BEEN MADE FOR THE INSTALLATION.

PLEASE READ THESE INSTRUCTIONS CAREFULLY PRIOR TO ASSEMBLY AND USE.



- MAKE SURE ALL ACCESS PACKAGING IS REMOVED BEFORE ASSEMBLING.
- IT IS ADVISABLE WHEN HANDLING LARGE COMPONENTS TO HAVE TWO PEOPLE DURING ASSEMBLY.
- PLEASE REFER TO THE PARTS LIST AND ASSEMBLY DIAGRAM AS NECESSARY.
- ASSEMBLY SHOULD BE CARRIED OUT ON AN OPEN, FLAT, LEVEL SURFACE. AVOIDING SURFACES THAT HAVE CRACKS OR OPENINGS.



- TO PREVENT ANY POSSIBLE DAMAGES, ENSURE ITEMS ARE LIFTED CORRECTLY AND SAFELY, WHILST BEING MOVED FROM ONE LOCATION TO ANOTHER.
- DO NOT FORCE PARTS TOGETHER AS THIS CAN RESULT IN DAMAGE TO THE PRODUCT.
- WEAR CORRECT PPE - SAFETY GLOVES AND GLASSES. EDGES AND CORNERS CAN CAUSE MINOR CUTS IF IMPROPERLY HANDLED DURING ASSEMBLY, SOME DRILLING WILL BE REQUIRED.
- WHEN APPLICABLE, TIGHTEN ALL COMPONENTS BY HAND FIRST. ONCE ALL STEPS ARE COMPLETED, GO BACK AND FULLY TIGHTEN TILL FIRMLY SECURE WITH THE RECOMMENDED HAND TOOL.

4. SITE PREPARATION AND UTILITY ACCESS HOLES



- THE FIRST STAGE OF ASSEMBLING YOUR OUTDOOR KITCHEN IS PREPARATION. AS PER OUR PRE-INSTALLATION GUIDELINES, THE AREA SHOULD PROVIDE A SOLID AND FLAT SURFACE AND BE CLEAR OF ANY OBSTRUCTIONS.



- ALL PLUMBING, MAINS GAS AND ELECTRICS SERVICES SHOULD ALIGN WITH ANY APPLIANCES YOU MAY HAVE IN YOUR OUTDOOR KITCHEN LAYOUT, AND BE LEFT IN A SAFE AND COMPLAINT CONDITION.



- ALTHOUGH OUR OUTDOOR KITCHEN CABINETS ARE SUPPLIED WITH MULTIPLE SERVICE ACCESS POINTS, SOME LAYOUTS MAY REQUIRE ADDITIONAL HOLES TO BE DRILLED DURING INSTALLATION.
- OUR INSTALLATION TEAM WILL HAPPILY REMOVE ALL ACCESS PACKAGING ONCE THE INSTALLATION HAS BEEN COMPLETED. HOWEVER, IF YOU ELECT FOR A SUPPLY ONLY THEN ALL PACKAGING SHOULD BE RECYCLED WHERE POSSIBLE.

5. LEVELLING A KITCHEN CABINET

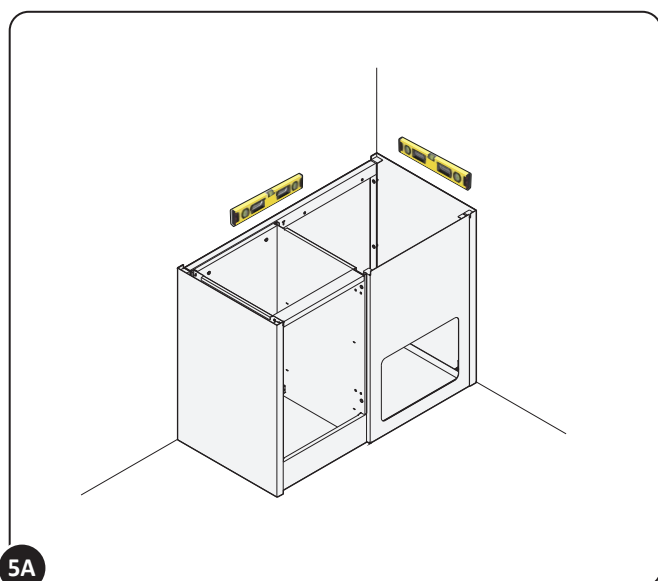
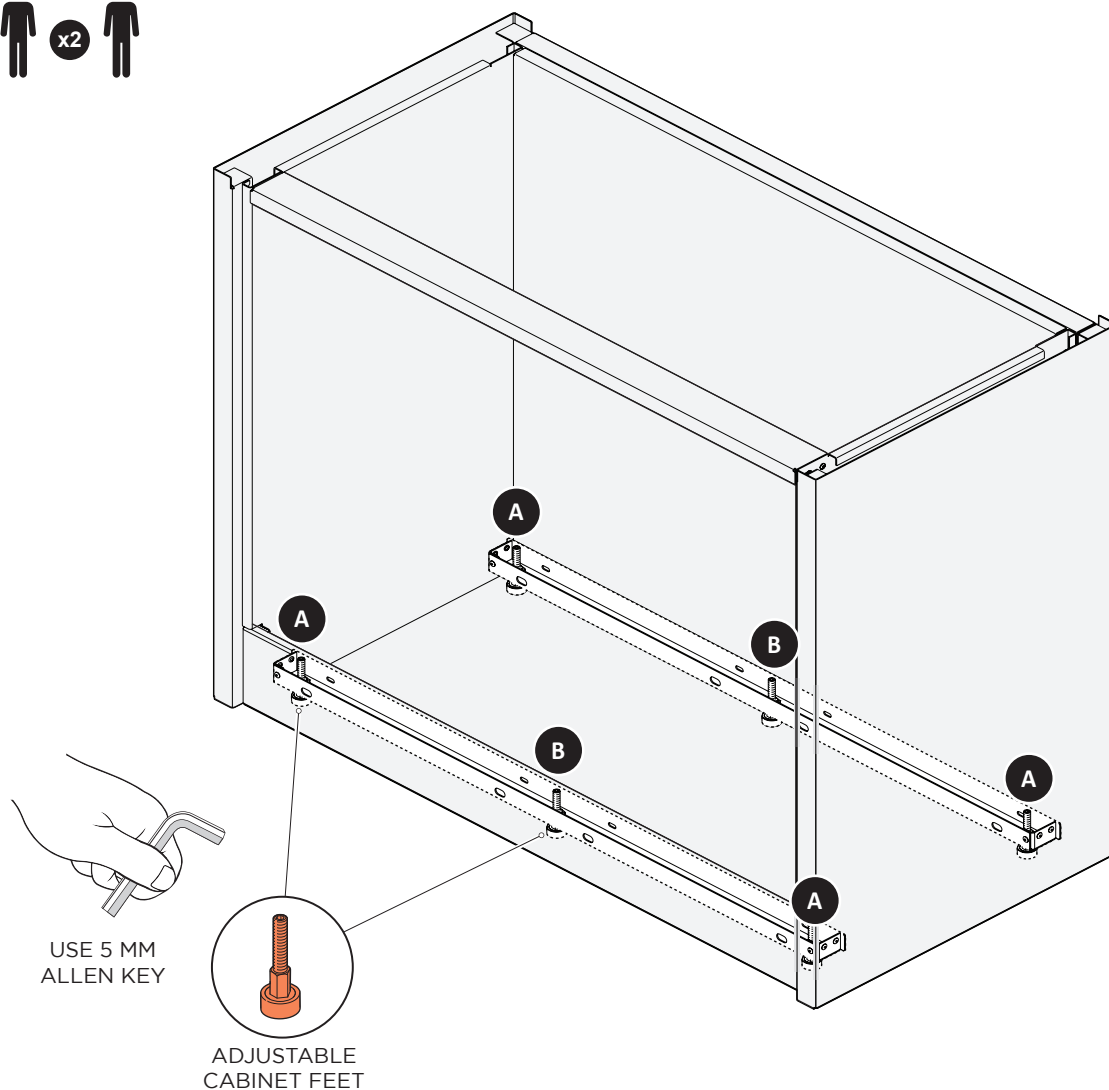

STARTING AT A CORNER, POSITION THE FIRST CABINET AND IDENTIFY ANY LOW POINTS USING A SPIRIT LEVEL

TOOLS REQUIRED:
5MM ALLEN KEY
SPIRIT LEVEL

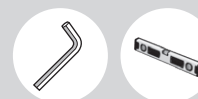

CABINET FOOT KEY:

- A** PRIMARY
- B** SECONDARY

5. LEVELLING A KITCHEN CABINET CONTINUED

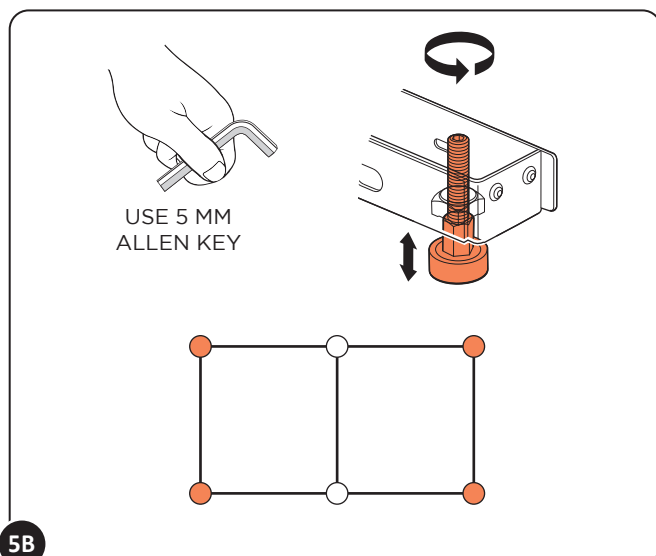

5B

ADJUST THE OUTER 'PRIMARY' CABINET FEET TO RAISE OR LOWER THE CABINET UNTIL LEVEL.

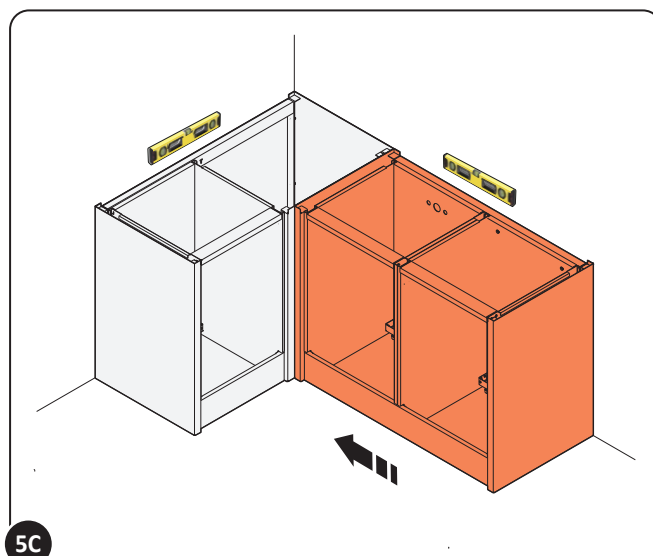

5C

POSITION THE SECOND CABINET, CHECK THE LEVELS AND ADJUST AS PER STEP 5B.

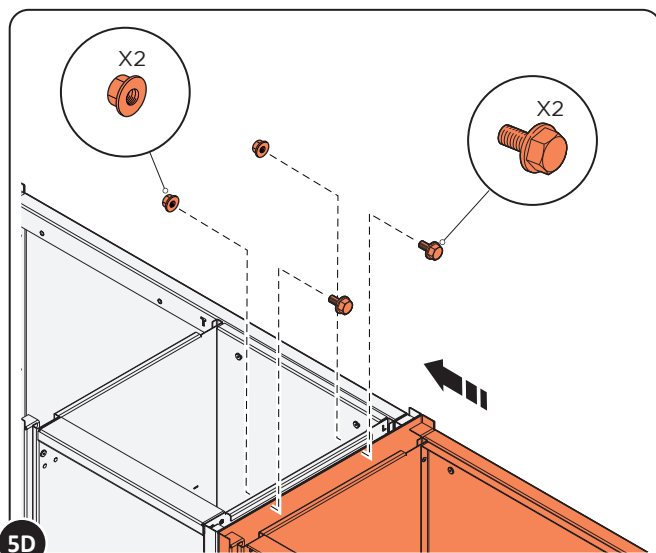

5D

SECURE THE CABINETS TOGETHER USING ONE OF THE METHODS SHOWN IN SECTION 6.

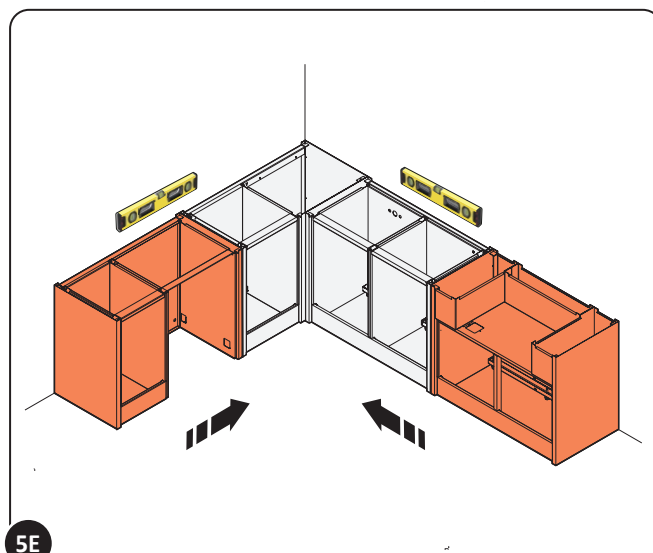

5E

CONTINUE ADDING CABINETS, ONE AT A TIME, LEVELING AND SECURING INTO POSITION, UNTIL YOU HAVE THE FULL LAYOUT.

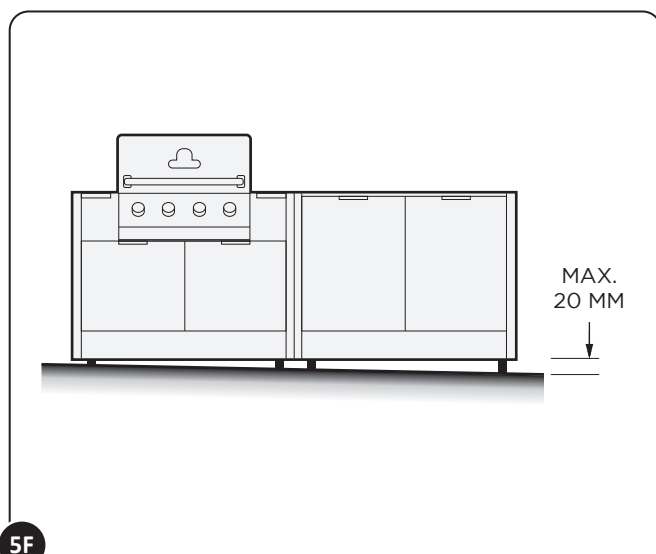

5F

WE WOULD RECOMMEND A MAXIMUM ADJUSTMENT OF 20 MM ALONG THE TOTAL LENGTH OF THE CABINETS. OTHERWISE THEY SHOULD RUN WITH THE GRADIENT OF THE FLOOR.

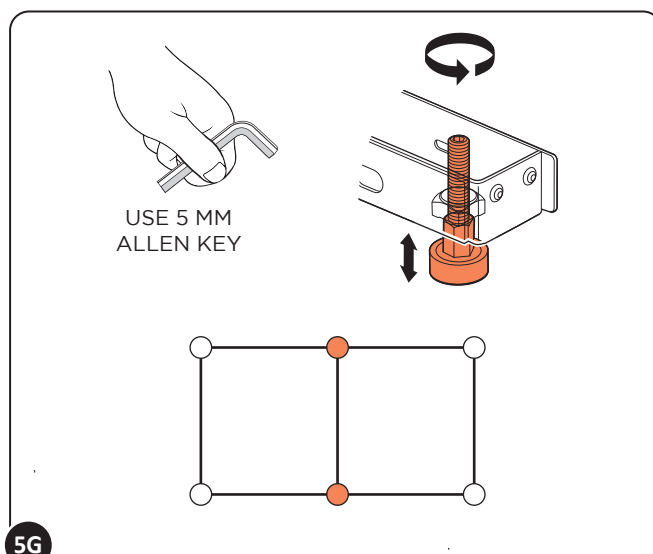

5G

FINALLY ADJUST ANY 'SECONDARY' CABINET FEET UNTIL THEY COME INTO CONTACT WITH THE FLOOR.

6. JOINING TWO KITCHEN CABINETS (OPTION 1)



ROTATE 90°
CLOCKWISE

DRILL JIG
0270-326



**IMPORTANT: WHEN DRILLING
PPE MUST BE WORN!**

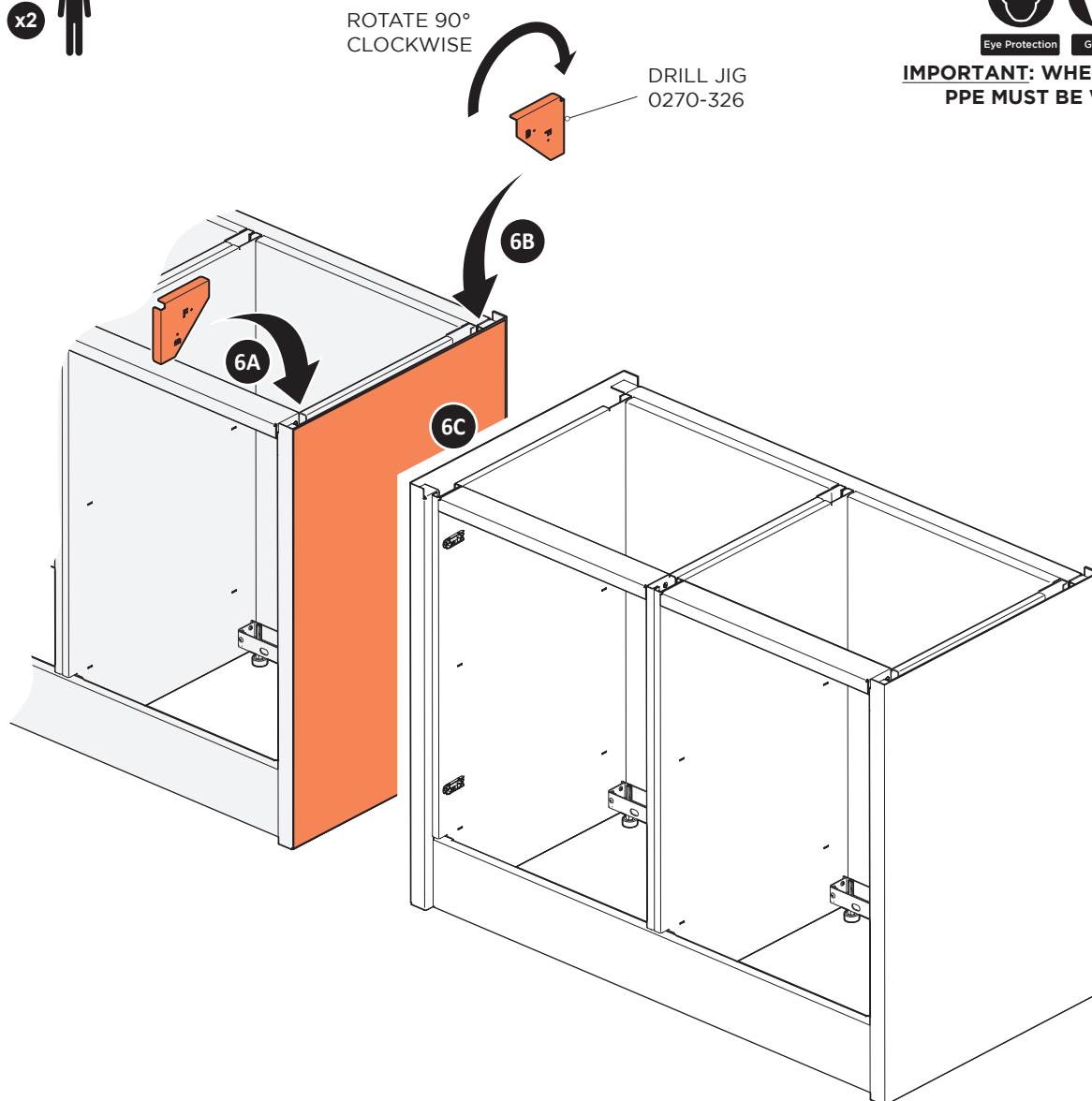

TOOLS REQUIRED:
POWER DRILL
MARKER

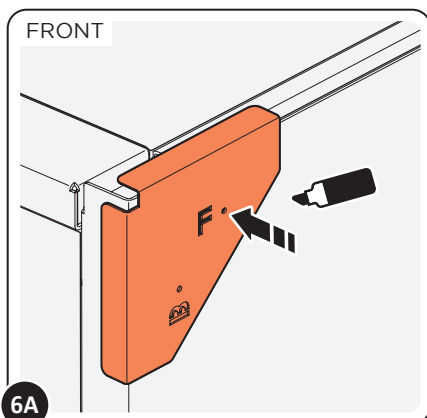

6A

USING THE DRILL JIG, MARK THE TOP HOLE ONLY AT BOTH THE FRONT AND REAR OF THE CABINET SIDE PANEL.

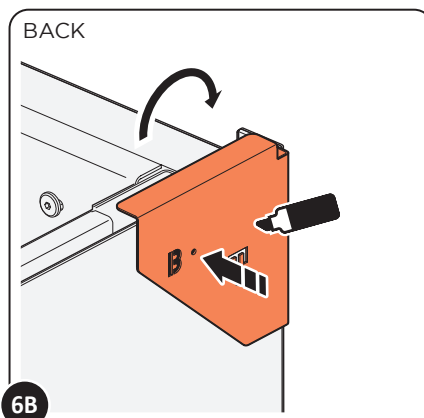

6B

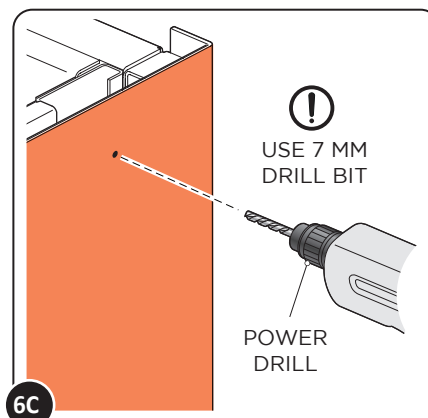

6C

WITH THE JIG REMOVED, DRILL 2 X 7 MM HOLES THROUGH THE OUTER FACES OF BOTH PANELS. READY FOR JOINING TOGETHER.

6. JOINING TWO KITCHEN CABINETS (OPTION 1) CONTINUED

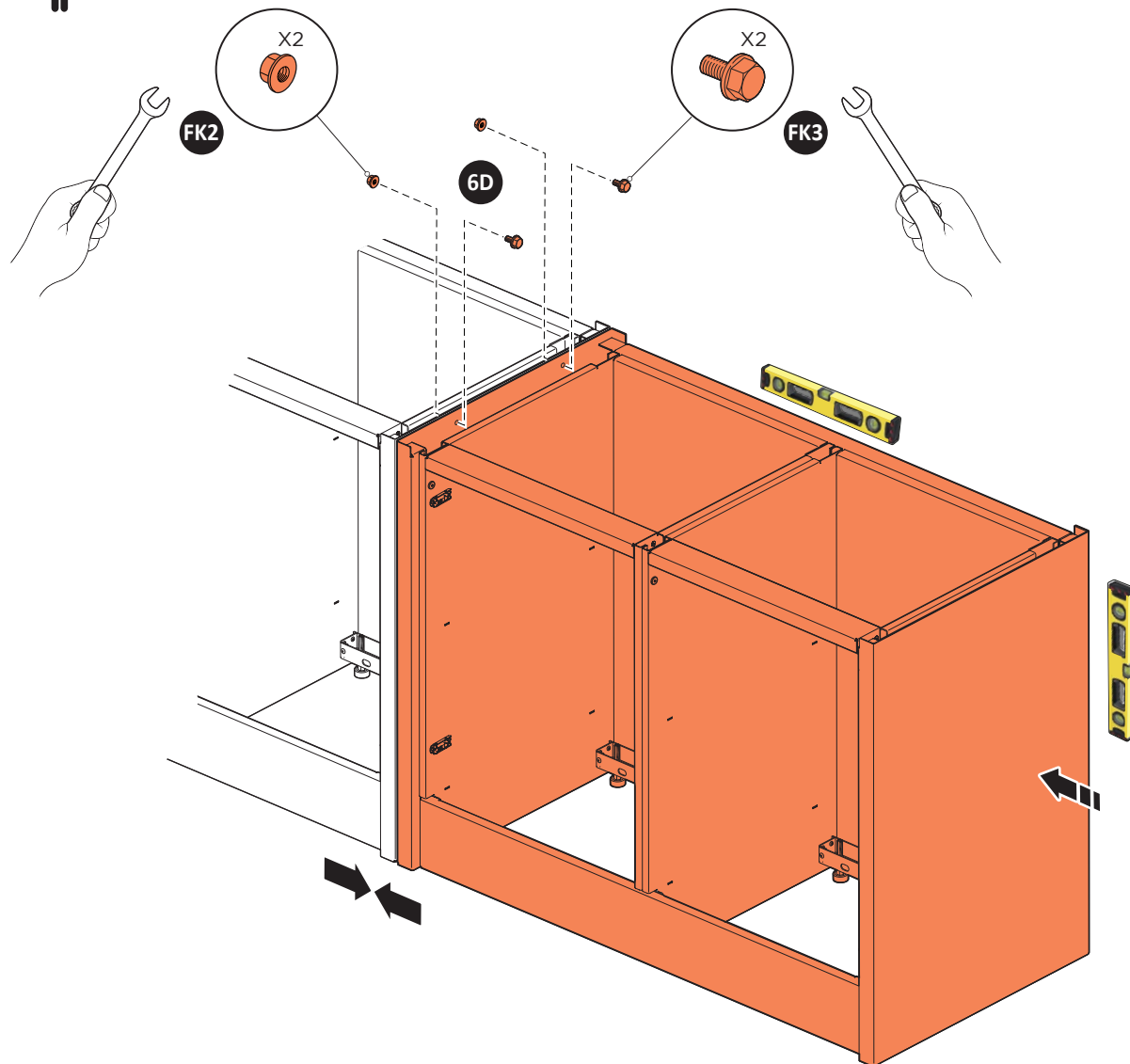

TOOLS REQUIRED:
10MM SPANNER
SPIRIT LEVEL

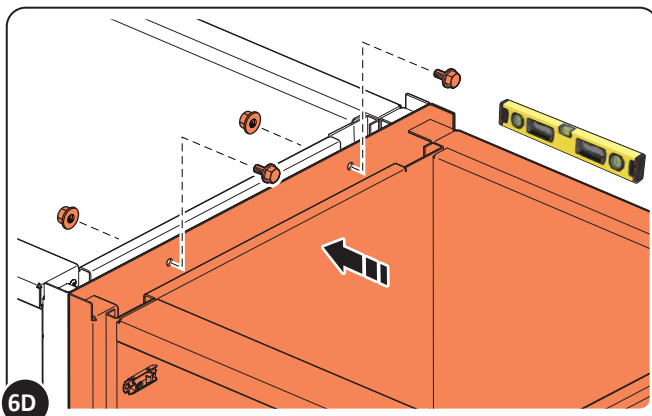

6D
POSITION THE SECOND CABINET IN PLACE AND LOOSELY CONNECT IT TO THE FIRST CABINET USING THE FIXINGS FK2 & FK3.

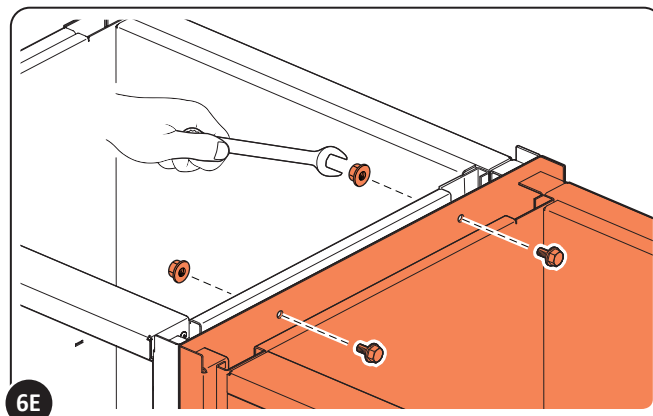

6E
ONCE THE SECOND CABINET IS LEVEL AND FLUSH, TIGHTEN UP THE FIXINGS FK2 & FK3, AS SHOWN ABOVE.

6. JOINING TWO KITCHEN CABINETS (OPTION 2)



IMPORTANT:
PPE MUST BE WORN!

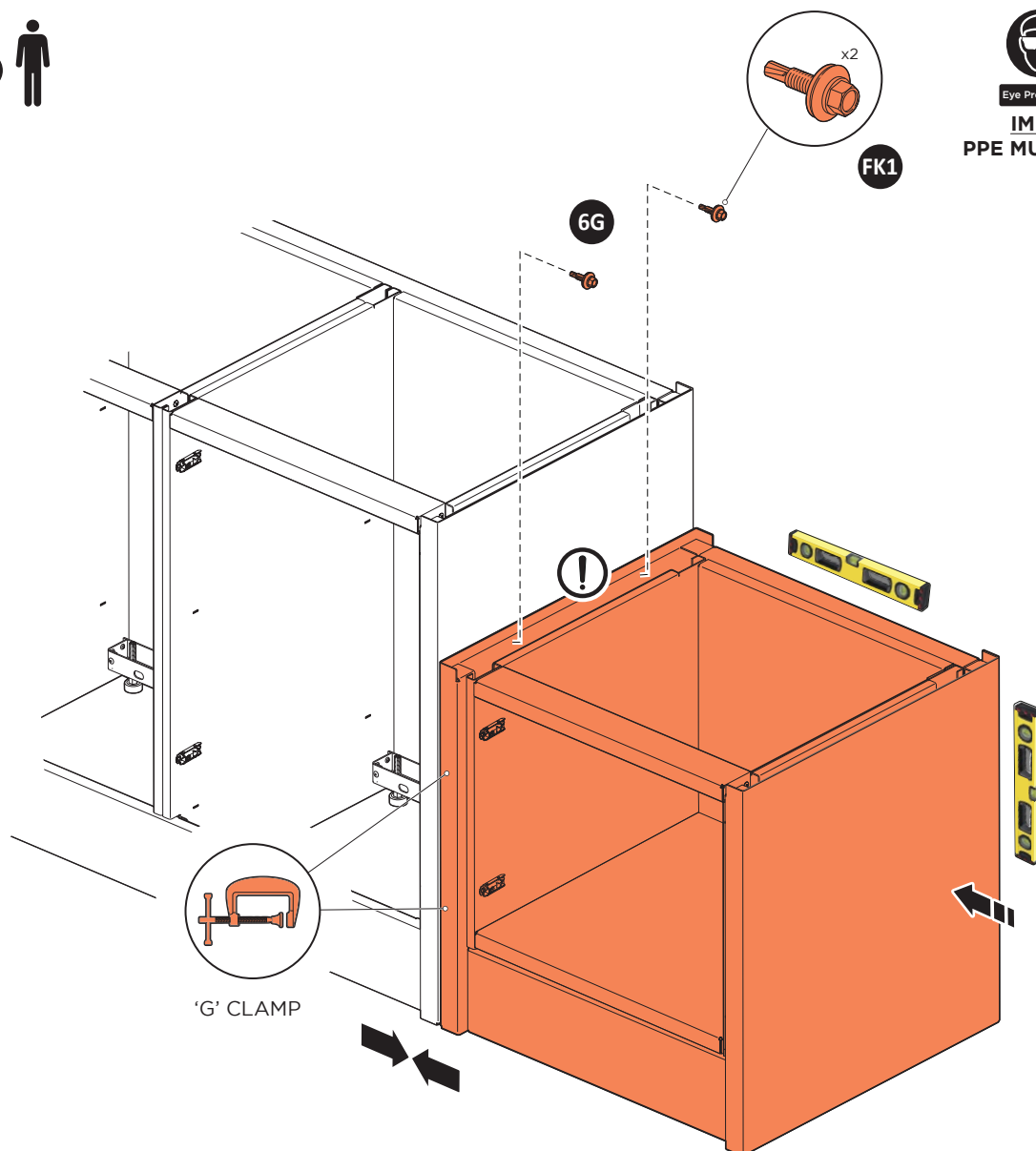

TOOLS REQUIRED:
'G' CLAMPS
10MM SOCKET
SPIRIT LEVEL

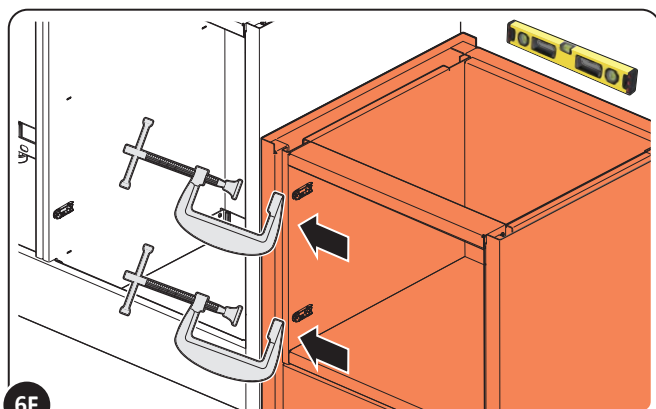

6F

POSITION THE SECOND CABINET IN PLACE AND ENSURE IT'S LEVELED UP TO THE FIRST CABINET AS PER STEP 5. TEMPORARY SECURE CABINETS TOGETHER USING A SET OF CLAMPS.

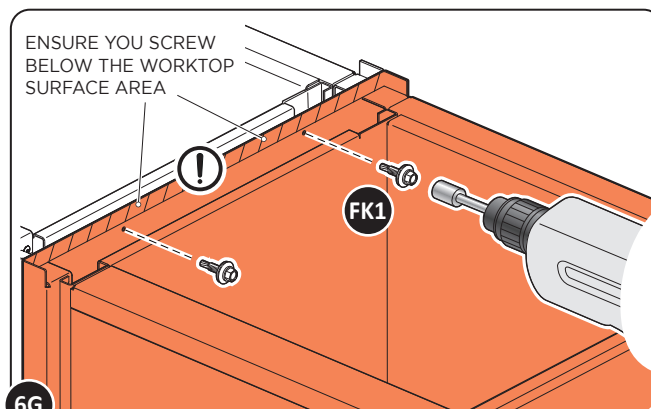

6G

ENSURE YOU SCREW BELOW THE WORKTOP SURFACE AREA. SECURE THE TWO CABINETS TOGETHER USING THE SELF-TAPPING SCREWS FK1. ENSURE THEY ARE INSERTED BELOW THE WORKTOP SURFACE AREA, AS SHOWN ABOVE.

7. WORKTOP INSTALLATION

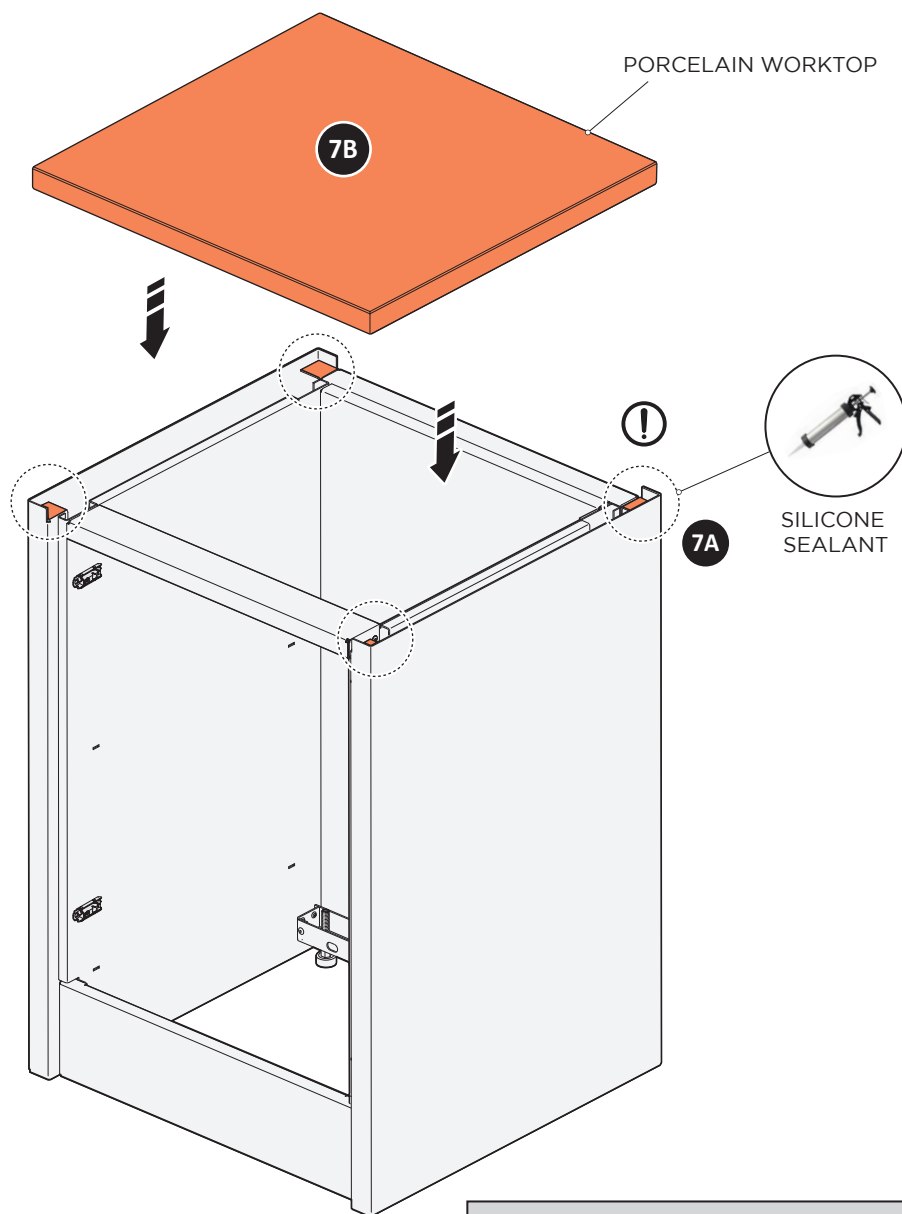

TOOL REQUIRED:
SEALANT & GUN
RUBBER Mallet
SPIRIT LEVEL

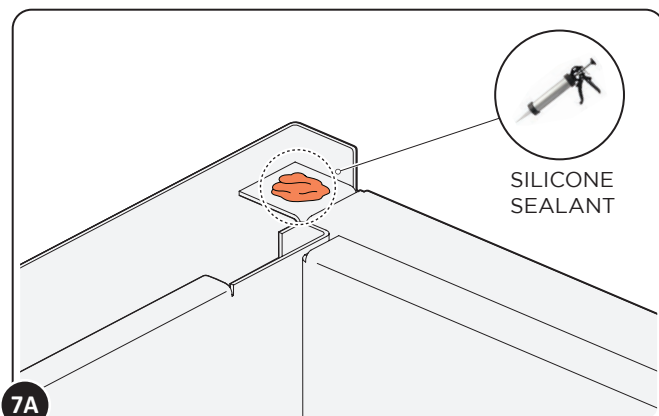

APPLY A BEAD OF SILICONE IN EACH CORNER OF THE CABINET PRIOR TO INSTALLING THE WORKTOP.

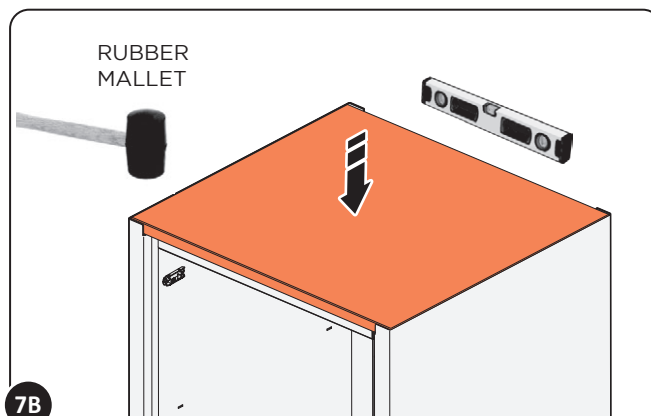

USING A SOFT RUBBER Mallet, GENTLY TAP DOWN ANY HIGH SPOTS UNTIL THE WORKTOP IS LEVEL, CHECK BY USING A SPIRIT LEVEL.

8. SHELF INSTALLATION

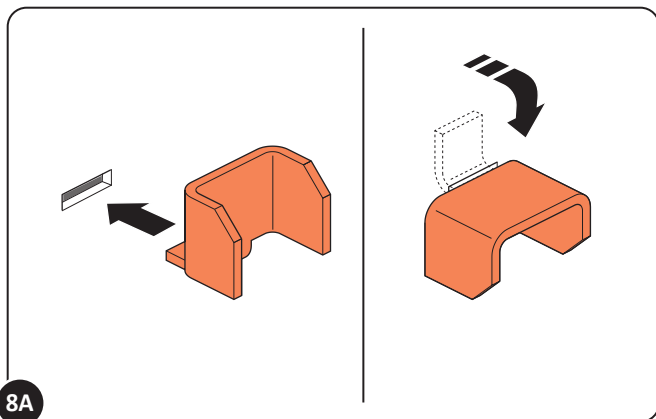
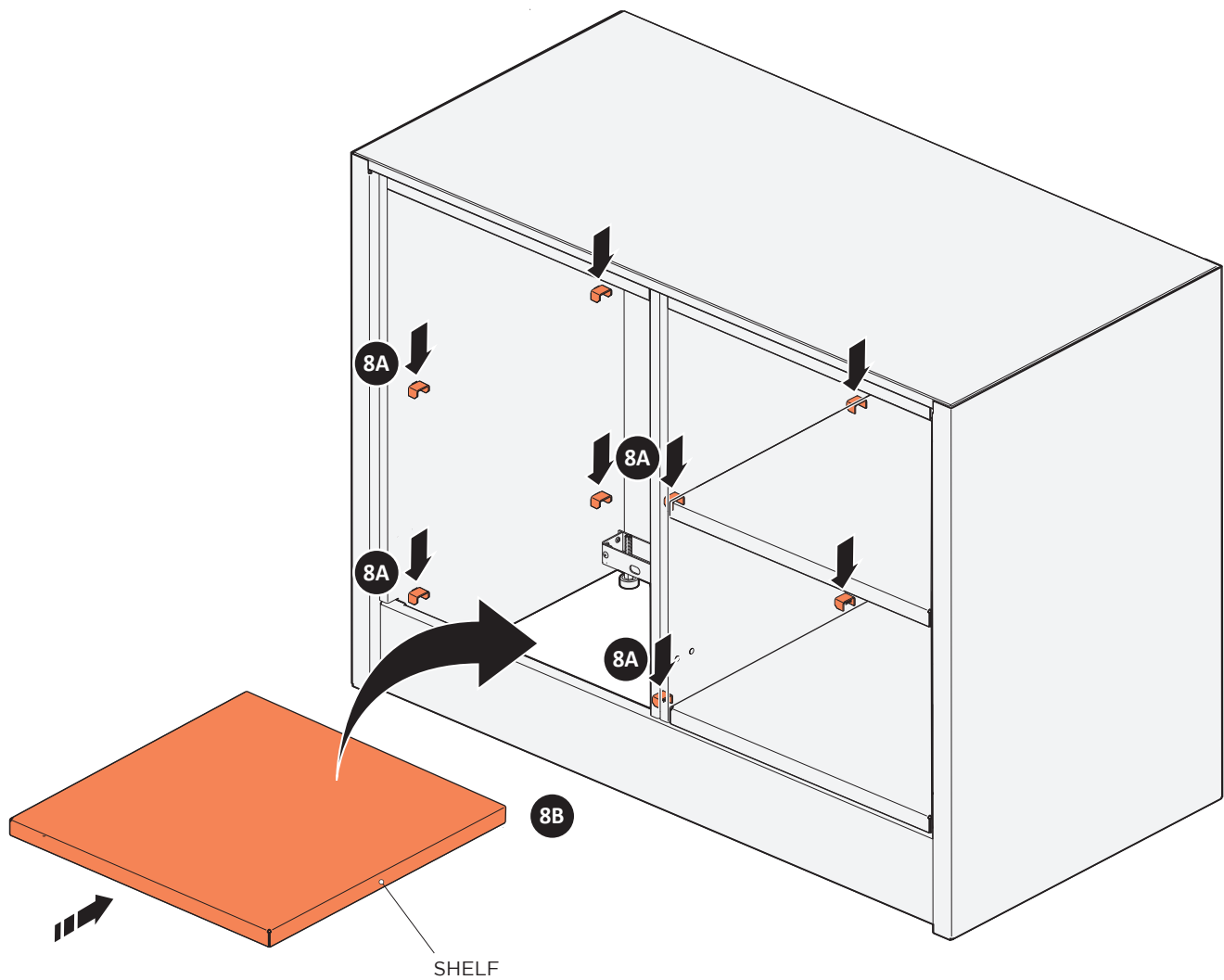

8A
LOCATE SHELF SUPPORT CLIP INTO ANCHORING POINTS AND ROTATE DOWNWARDS TO SECURE INTO POSITION.

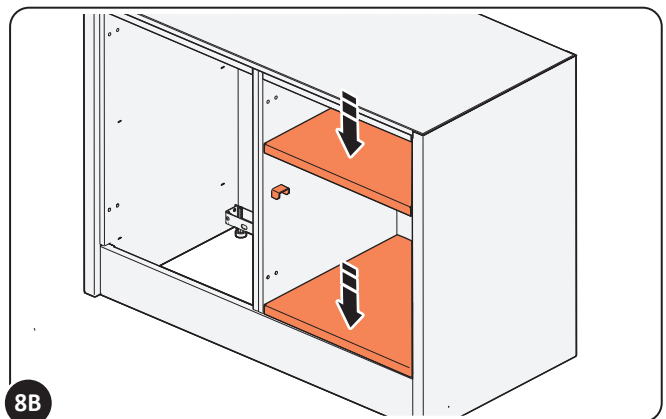

8B
CAREFULLY SLIDE SHELVES INTO POSITION AND REST ON TOP OF SHELF SUPPORT CLIPS.

9. CABINET DOOR INSTALLATION

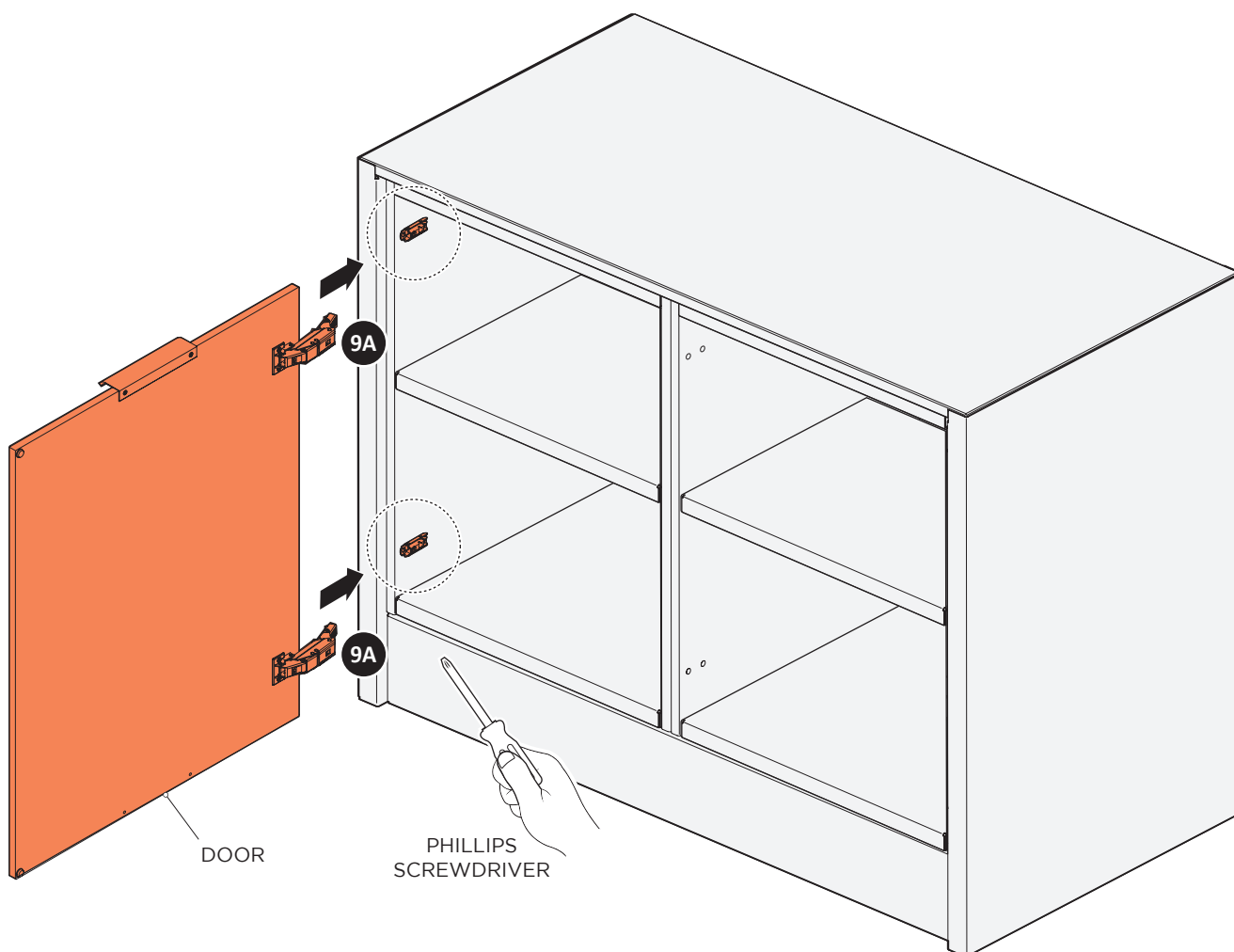

TOOL REQUIRED:
PHILLIPS SCREWDRIVER HEAD

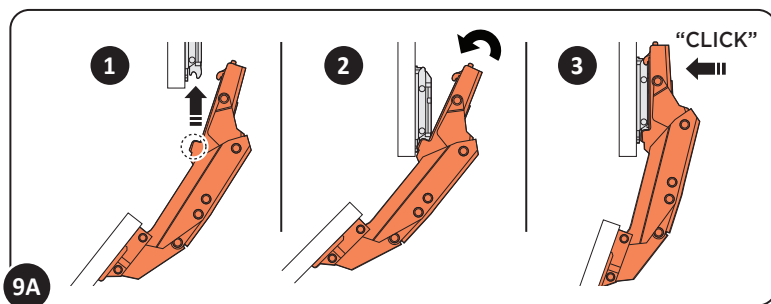

LOCATE DOOR HINGE INTO MOUNTING PLATE AND ROTATE UNTIL A "CLICK" SOUND IS HEARD.

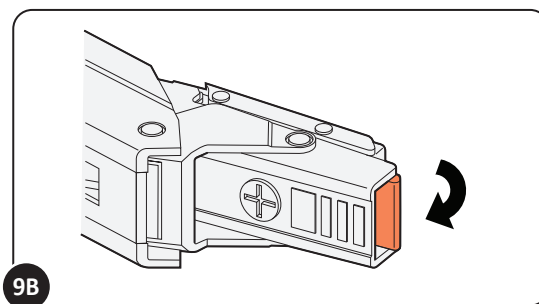

TO REMOVE DOOR, FLICK THE QUICK RELEASE LEVER AND GENTLY PULLING THE DOOR AWAY FROM THE CABINET.

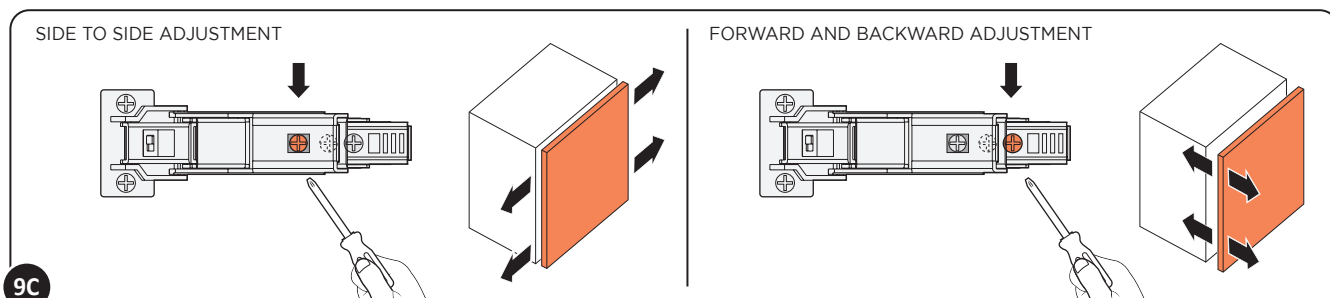

IF REQUIRED THE HINGES CAN BE ADJUSTED TO CORRECT ANY MISALIGNMENT AFTER FITTING.

10. BAR UNIT INSTALLATION



**IMPORTANT: WHEN DRILLING
PPE MUST BE WORN!**

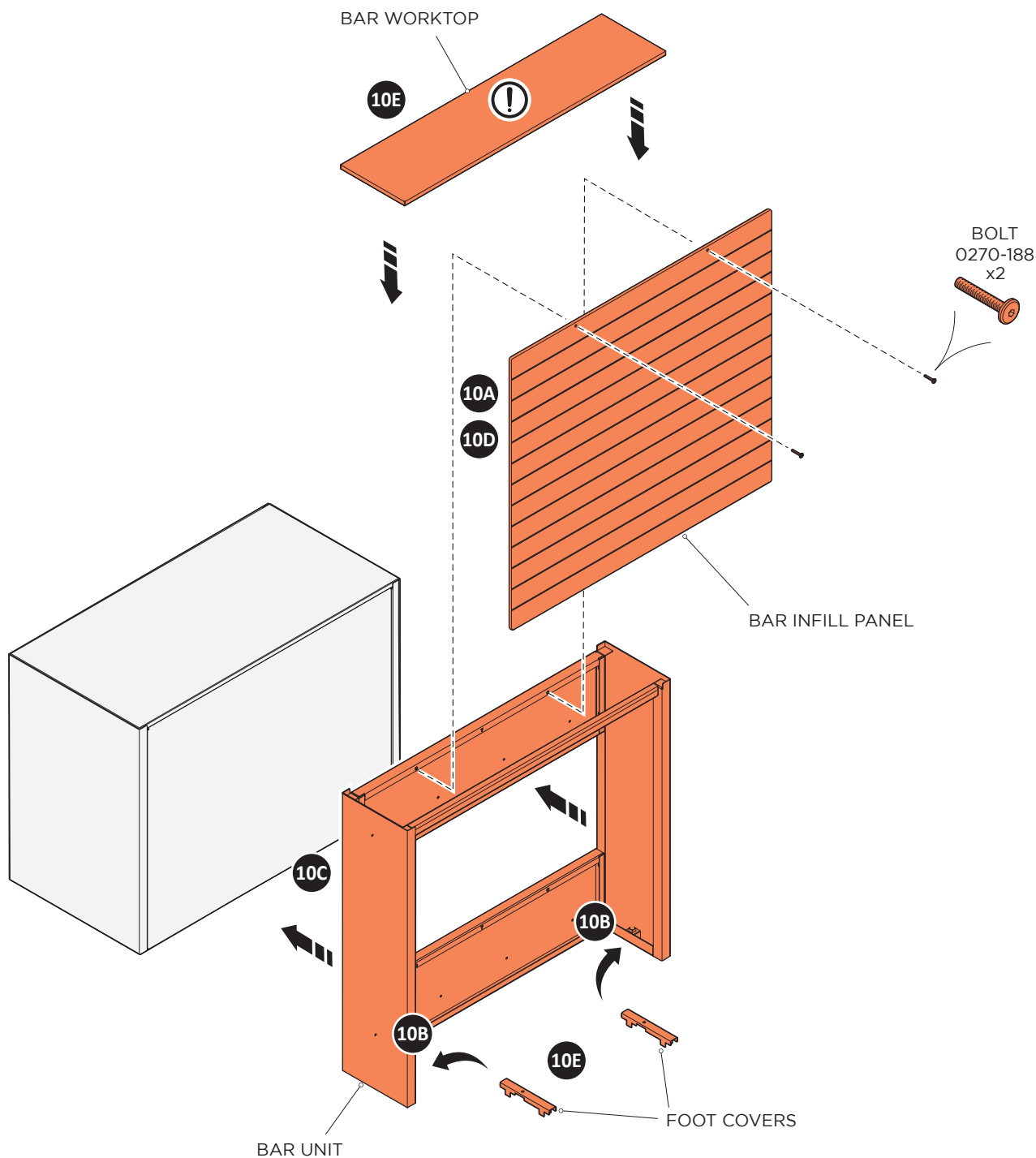

TOOLS REQUIRED:
POWER DRILL
4 & 5 MM ALLEN KEY
SPIRIT LEVEL
SEALANT & GUN



10. BAR UNIT INSTALLATION CONTINUED

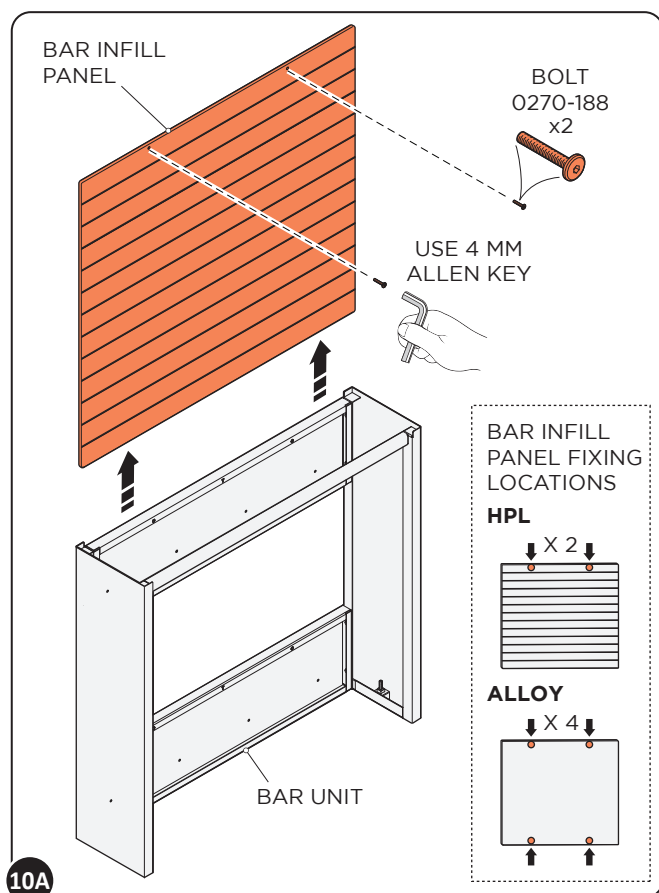

CAREFULLY REMOVE THE INFILL BY UNSCREWING BOLT FIXINGS 0270-188, CAREFULLY REMOVE INFILL PANEL BY LIFTING IN UPWARDS MOTION.

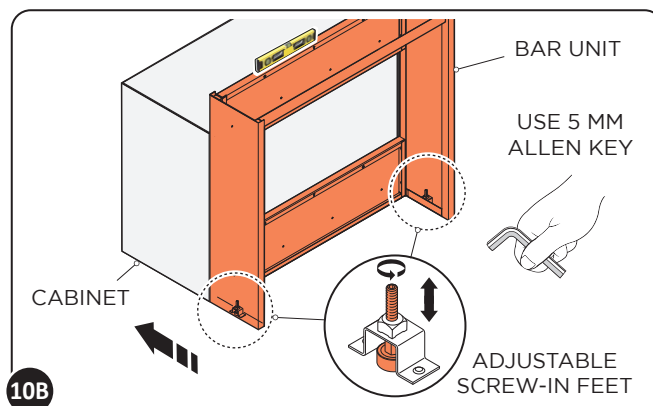

POSITION BAR UNIT AGAINST THE REAR OF A CABINET.
NOTE: USING A SPIRIT LEVEL, CHECK THAT THE UNIT IS LEVEL AND ADJUST FEET AS REQUIRED, AS SHOWN ABOVE.

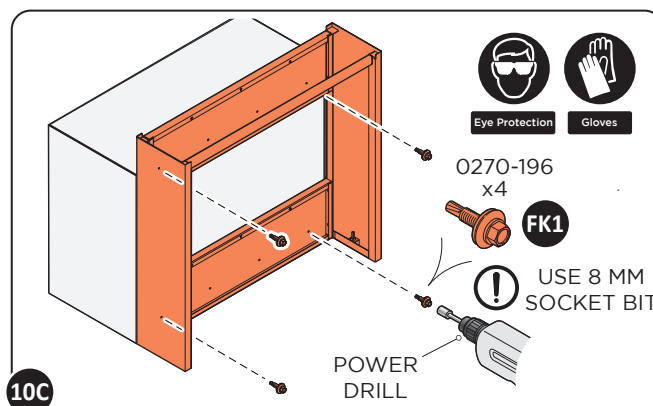

SECURE BAR UNIT TO CABINET USING THE SELF-TAPPING FK1 SCREWS. AT X4 LOCATIONS, AS SHOWN ABOVE.

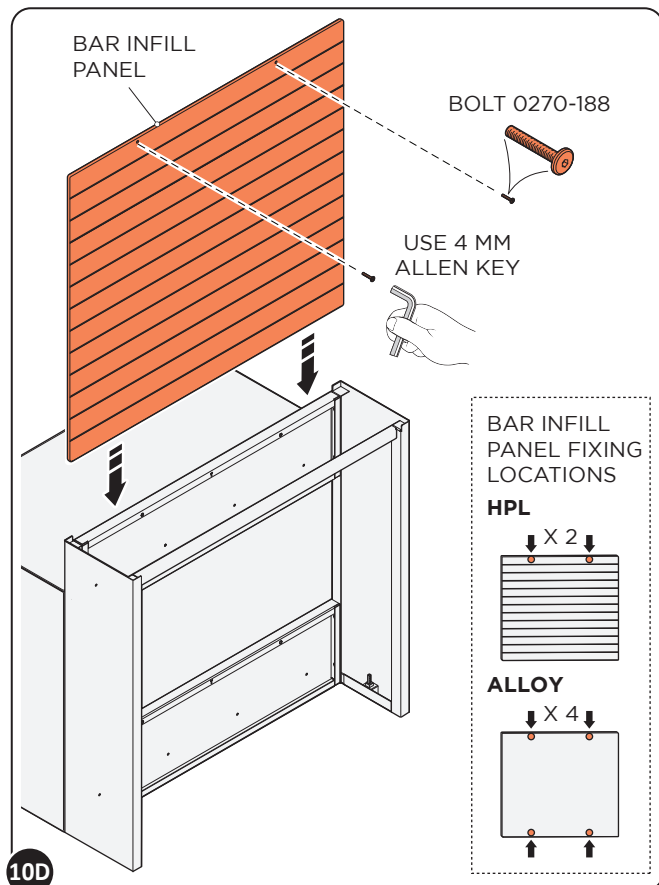

CAREFULLY LOWER THE INFILL PANEL BACK INTO LOCATION AND SECURE USING FIXINGS 0270-188.

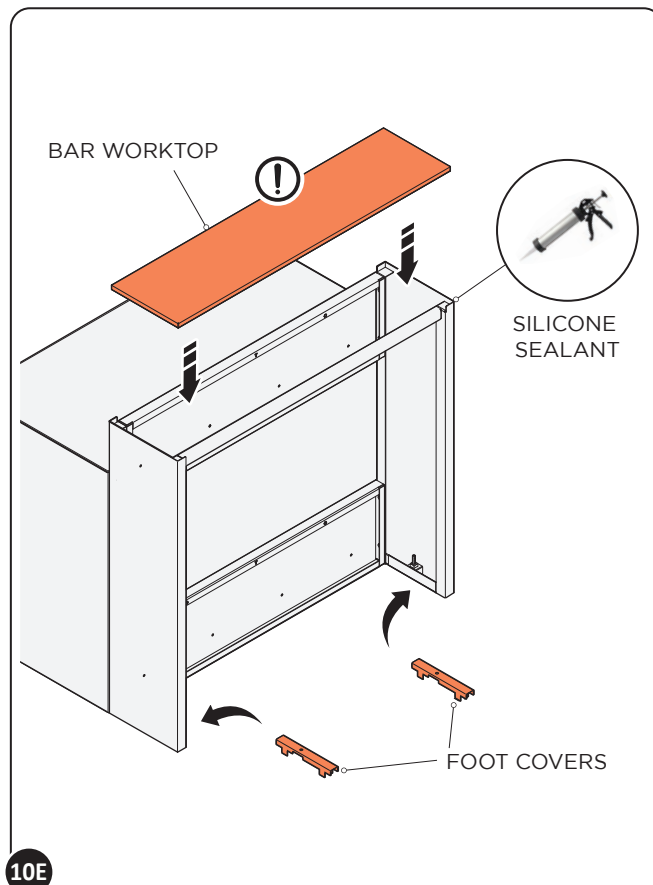

LOCATE BAR WORKTOP AND SECURE WITH SEALANT, AS SHOWN ABOVE. (REFER TO SECTION 7).

11. BASIN UNIT INSTALLATION

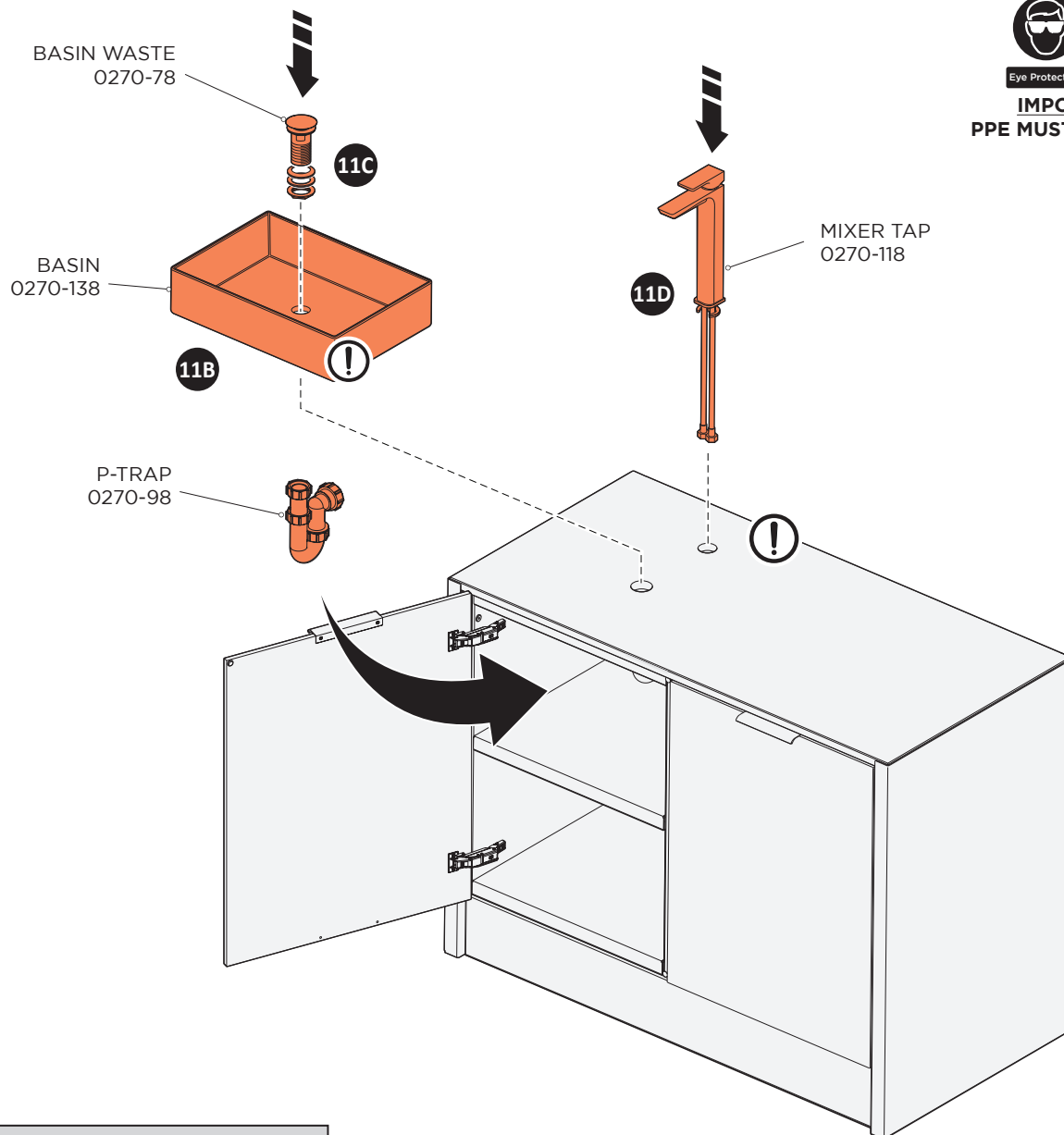

IMPORTANT:
PPE MUST BE WORN!

TOOL REQUIRED:
SEALANT & GUN



IMPORTANT: USE A QUALIFIED PLUMBER WHEN CONNECTING WATER SERVICES.

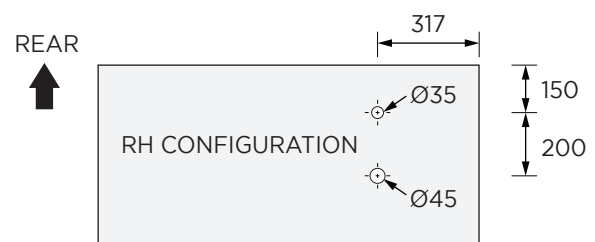
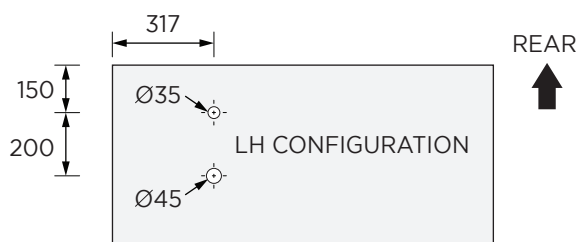

DEPENDING ON YOUR WORKTOP CONFIGURATION, MARK OUT THE MIXER TAP AND WASTE HOLE POSITIONS ON WORKTOP AND DRILL USING A DIAMOND HOLE CUTTER. **NOTE:** ALL DIAMENIONS IN MM.

11. BASIN UNIT INSTALLATION CONTINUED

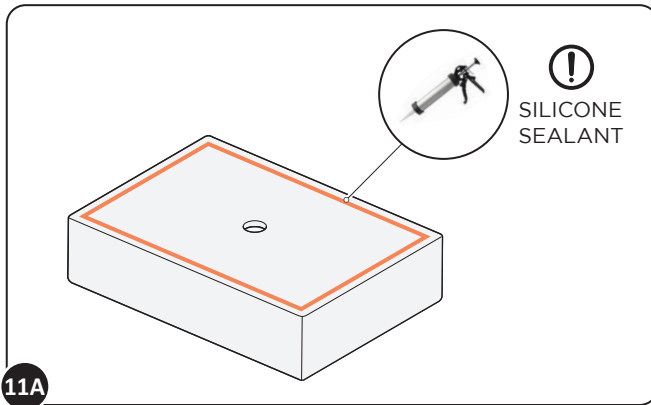

11A
APPLY A BEAD OF SILICONE UNDERSIDE THE BASIN, SLIGHTLY IN FROM THE OUTER EDGES, PRIOR TO INSTALLATION.

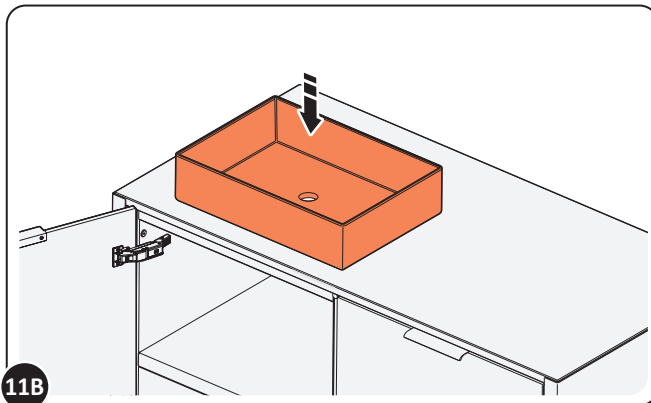

11B
CAREFULLY POSITION BASIN TO WORKTOP MAKING SURE THE DRAIN HOLE LINES UP, PRIOR TO P-TRAP & TAP INSTALLATION.

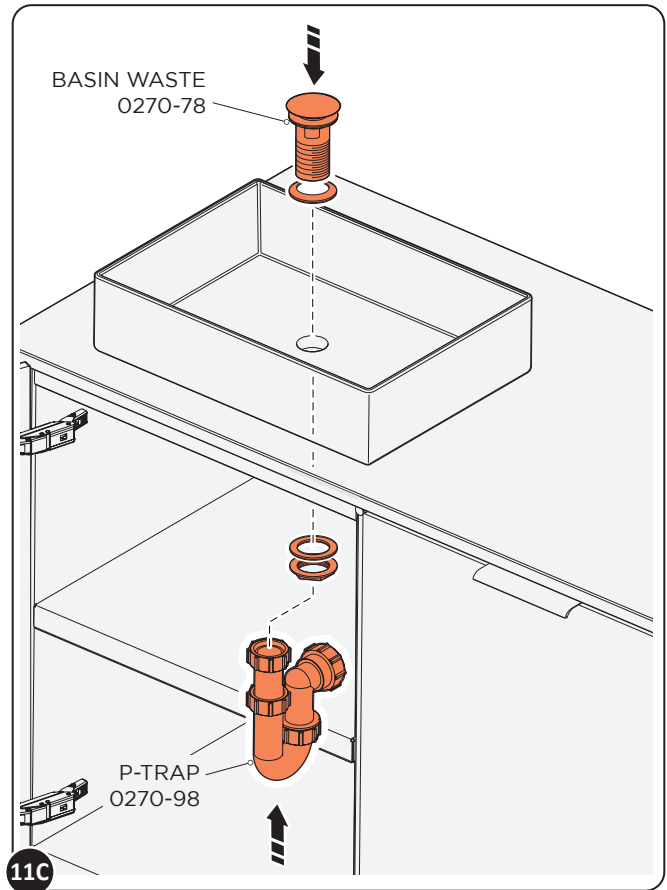

11C
SECURE BASIN WASTE ASSEMBLY TO BASIN USING FIXING SUPPLIED AND FIT THE P-TRAP INSIDE THE CABINET, AS SHOWN ABOVE.

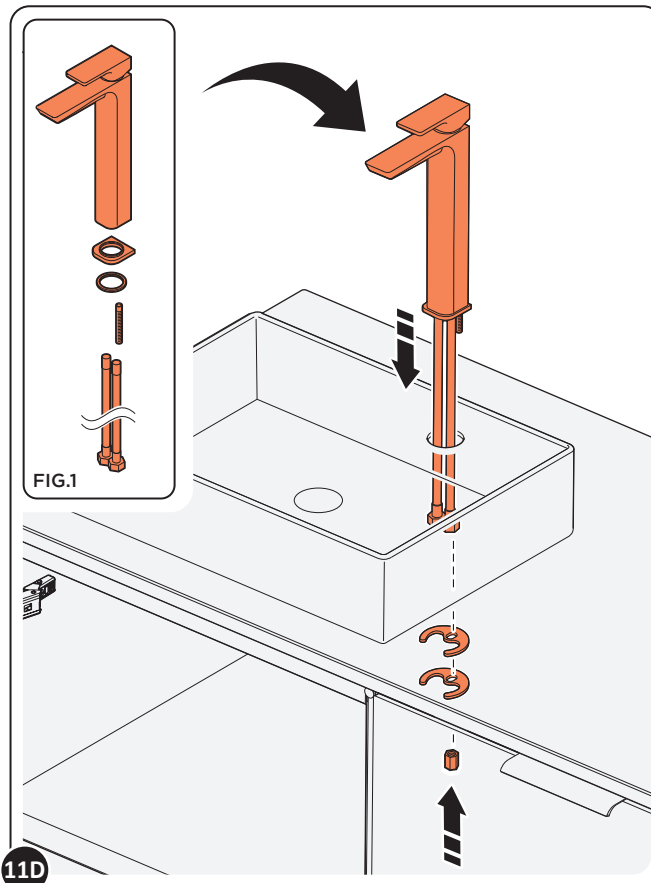

11D
PRE-ASSEMBLY THE MIXER TAP ASSEMBLY, AS SHOWN IN FIG.1 AND INSERT THROUGH THE WORKTOP FROM THE TOP. SECURE USING FIXINGS SUPPLIED AS SHOWN ABOVE..

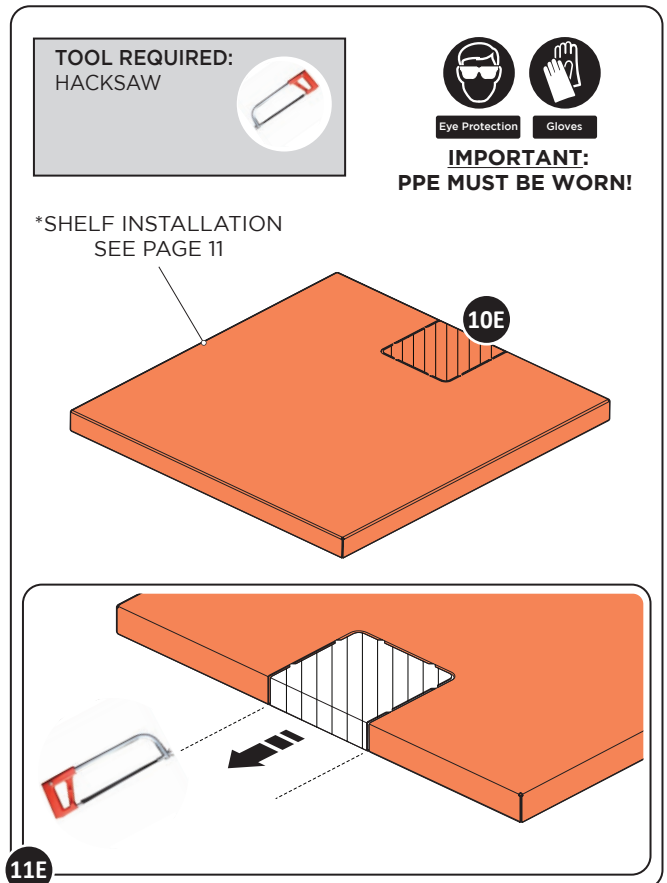

11E
IF REQUIRED, SHELF CUTOUTS CAN BE REMOVED, TO ENABLE INTERNAL PIPE RUNS.

12. COOLER UNIT INSTALLATION



COOLER UNIT

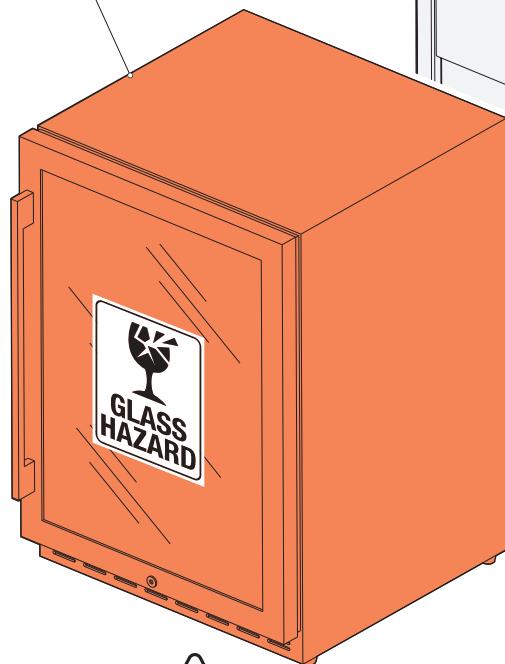

POWER
SUPPLY
CABLE



IMPORTANT:

WHILST POSITIONING THE COOLER
CARE MUST BE TAKEN NOT TO
DAMAGE THE GLASS DOOR OR TRAP
THE POWER CABLE BEHIND THE UNIT.

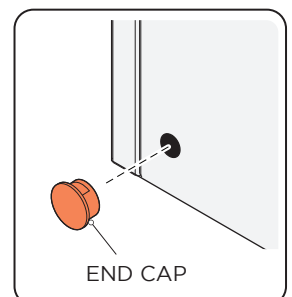
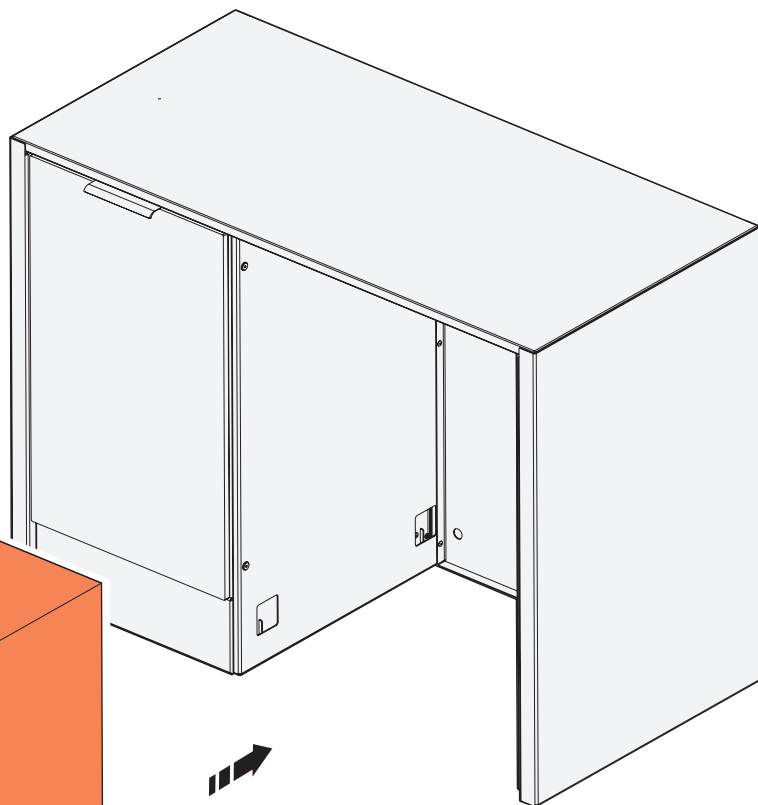

END CAP

CABLE EXIT POINTS ON
REAR OF CABINET



**IMPORTANT: USE A QUALIFIED ELECTRICIAN WHEN CONNECTING
POWER SUPPLY.**



IMPORTANT:

REFER TO YOUR APPLIANCE
USER MANUAL FOR
ASSEMBLY AND OPERATING
INSTRUCTIONS.



IMPORTANT:

REFER TO PRE-INSTALL
GUIDELINES REGARDING
ELECTRICAL
CONNECTION ADVISE.

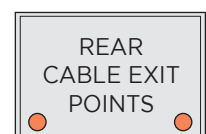

REAR
CABLE EXIT
POINTS

13. GAS BURNER UNIT INSTALLATION

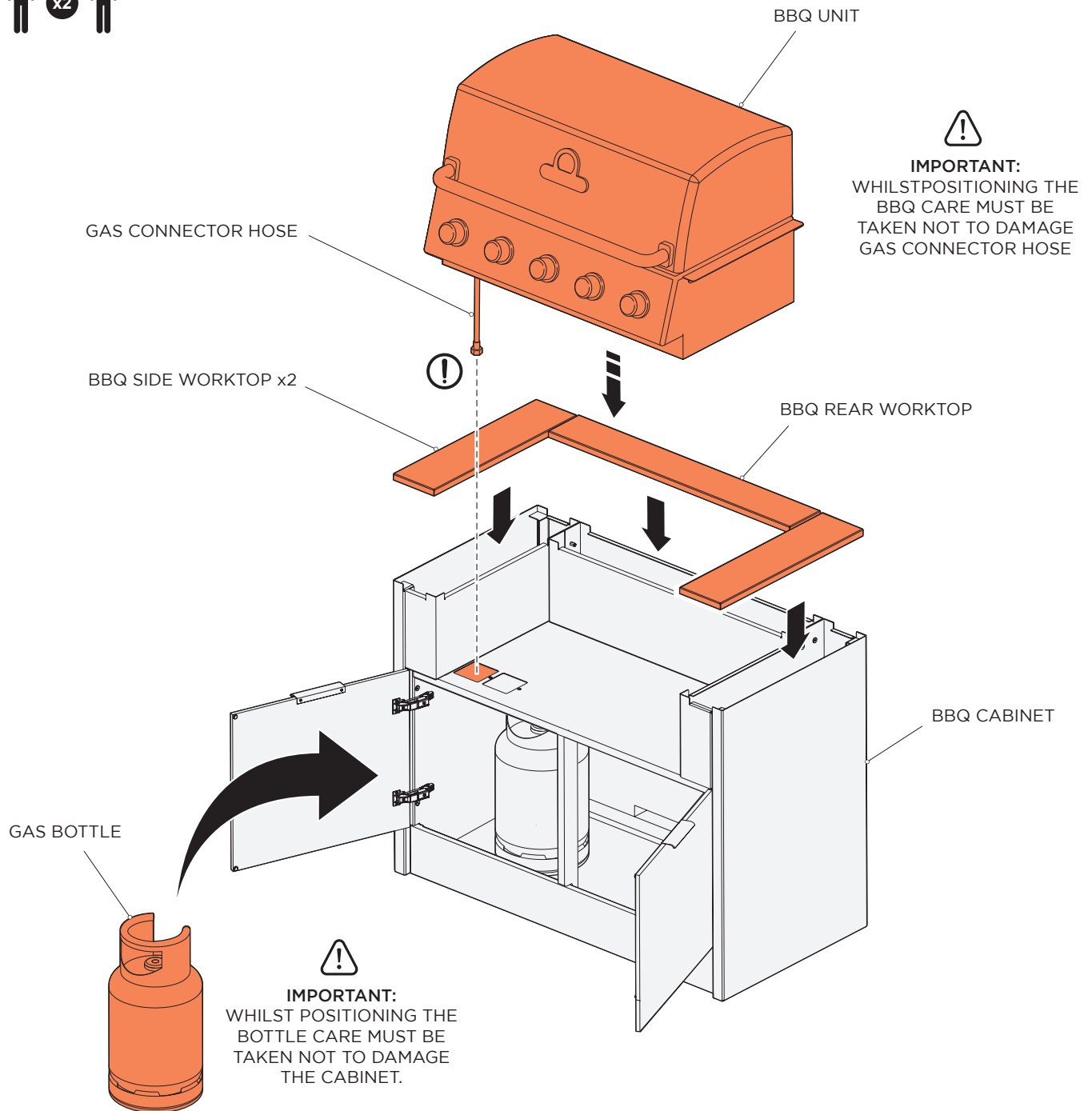

IMPORTANT:
REFER TO YOUR APPLIANCE
USER MANUAL FOR
ASSEMBLY AND OPERATING
INSTRUCTIONS.



IMPORTANT:
REFER TO PRE-INSTALL
GUIDELINES REGARDING
MINIMUM SAFE DISTANCE.

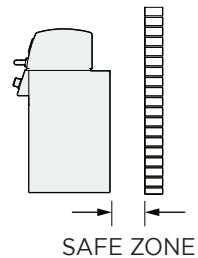

14. KAMADO UNIT INSTALLATION



IMPORTANT:
WHILST POSITIONING THE
KAMADO, CARE MUST BE
TAKEN NOT TO DAMAGE
THE WORKTOP SURFACE.

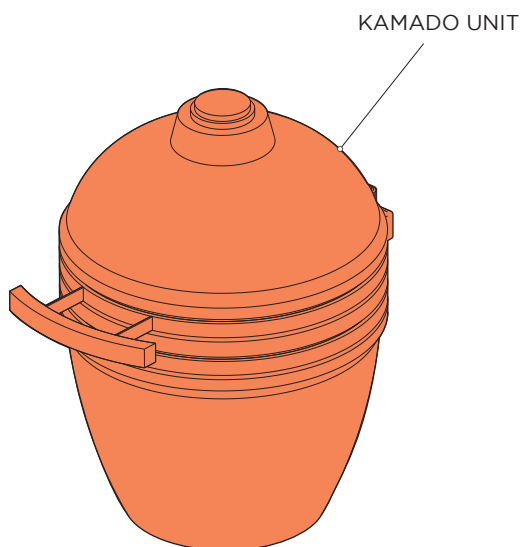

IMPORTANT:
FEET MUST BE INSTALL TO
ALLOW ADEQUATE AIRFLOW
UNDERNEATH THE KAMADO.

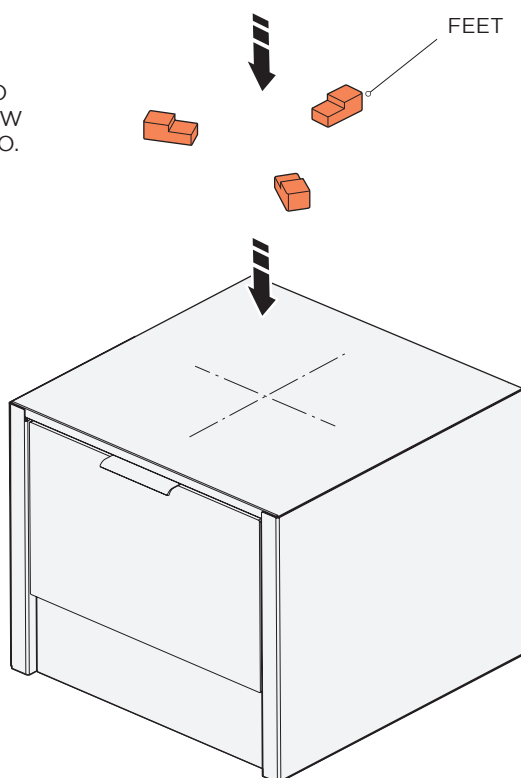

IMPORTANT:
REFER TO YOUR APPLIANCE
USER MANUAL FOR
ASSEMBLY AND OPERATING
INSTRUCTIONS.



IMPORTANT:
REFER TO PRE-INSTALL
GUIDELINES REGARDING
MINIMUM SAFE DISTANCE.

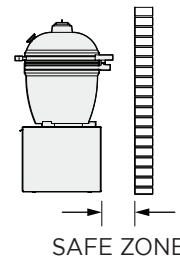

15. BACK PANEL INSTALLATION



IMPORTANT:
PPE MUST BE WORN!

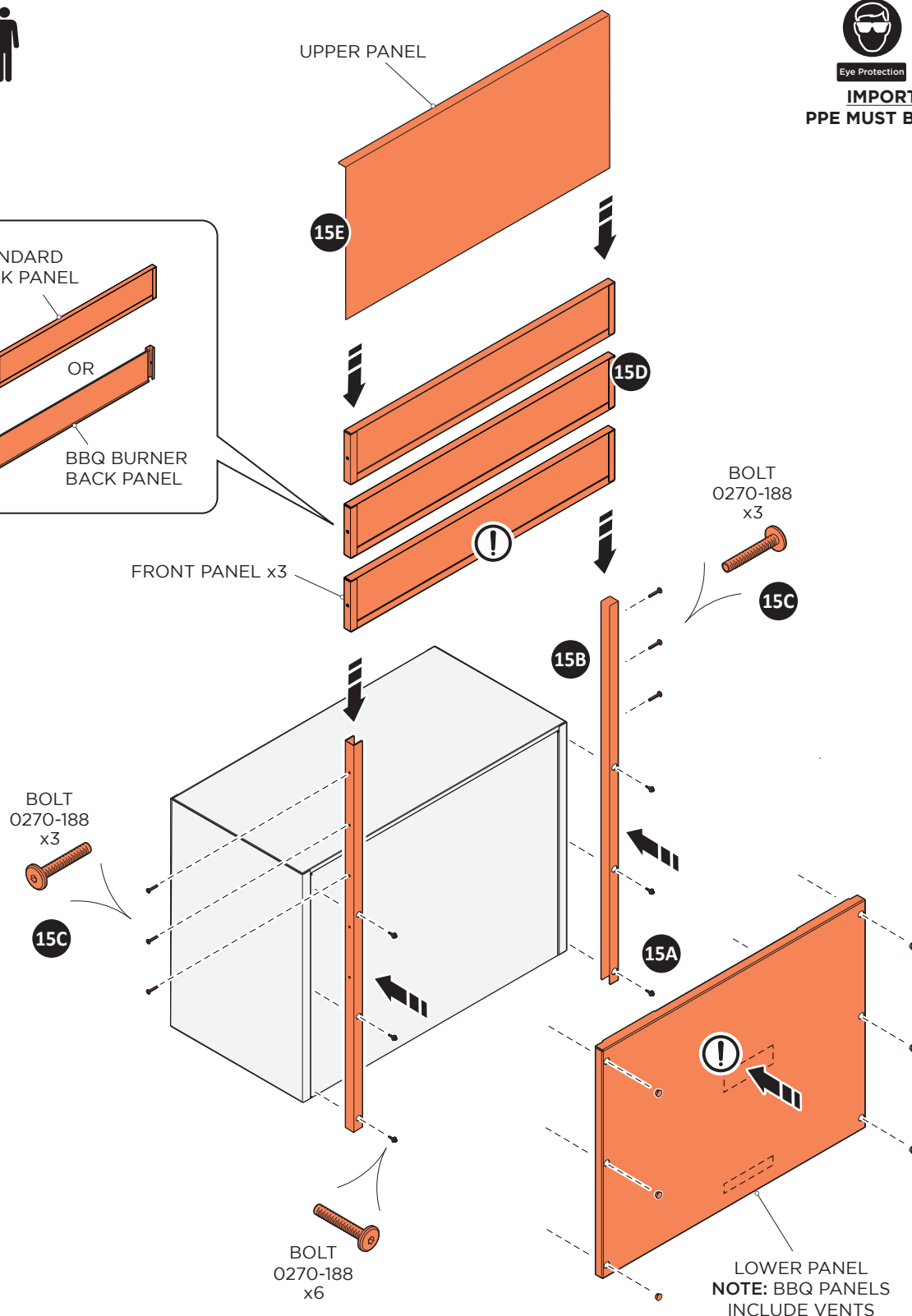
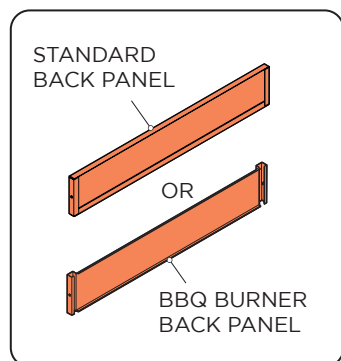

TOOLS REQUIRED:
POWER DRILL
4 MM ALLEN KEY



15. BACK PANEL INSTALLATION CONTINUED

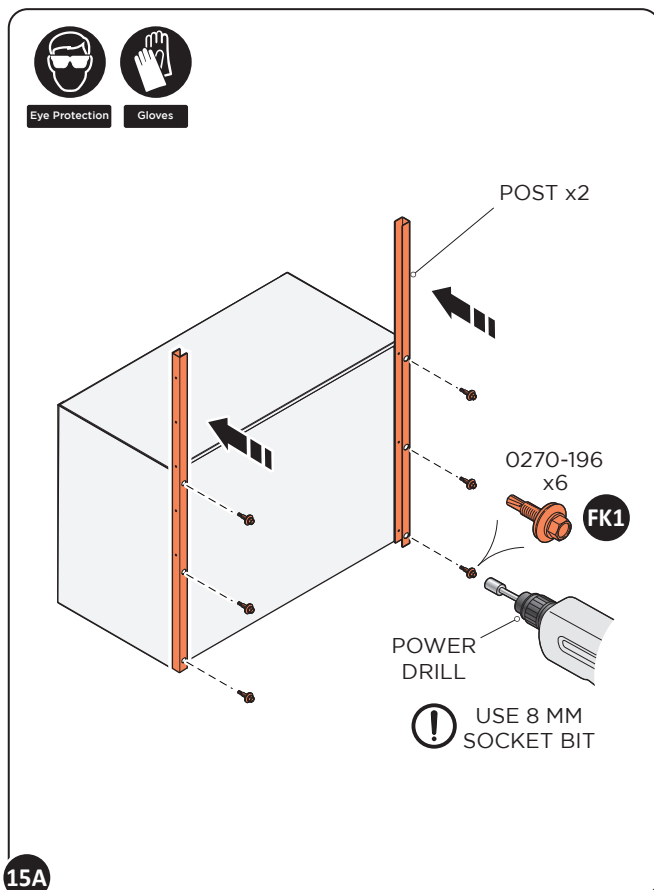

15A SECURE POST TO THE REAR OF CABINET USING THE SELF-TAPPING FK1 SCREWS. AT X6 LOCATIONS, AS SHOWN ABOVE.

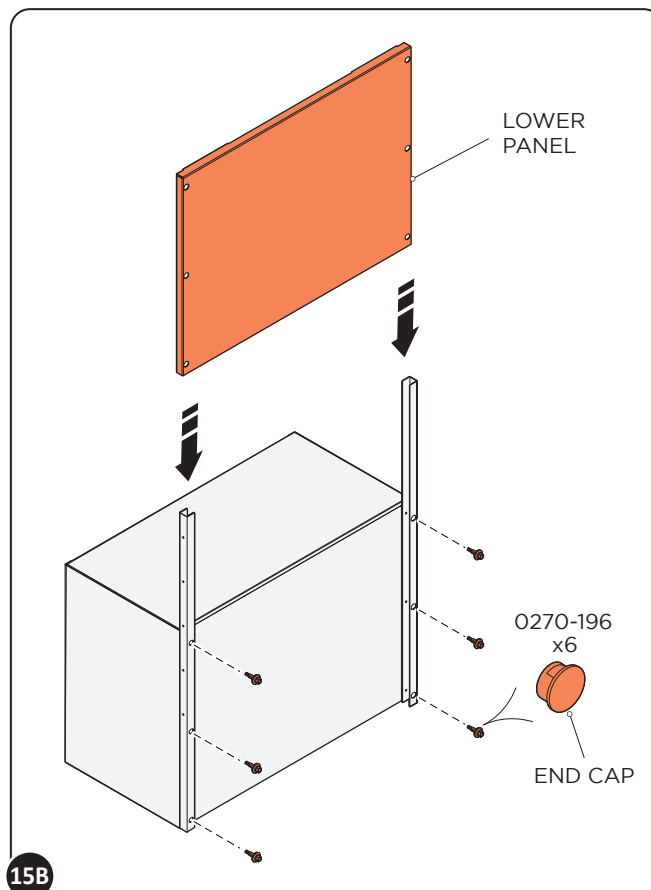

15B LOCATE AND CAREFULLY LOWER PANEL, BETWEEN BOTH UPRIGHT POSTS. **NOTE:** FOR BBQ CABINET PANELS, MAKE SURE VENT HOLES LINE UP. INSERT END CAPS AT X6 LOCATIONS, AS SHOWN ABOVE.

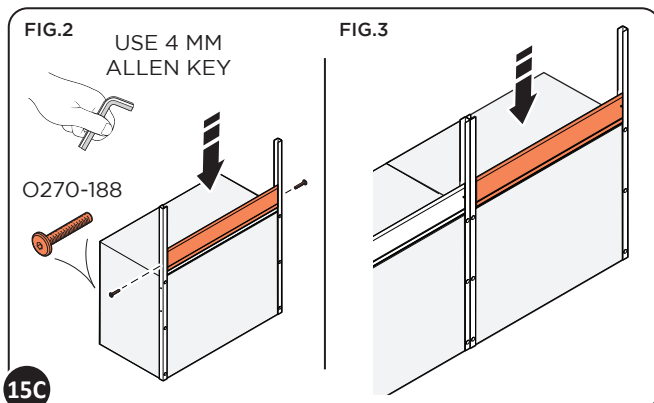

15C SECURE FRONT PANEL(S) TO POSTS ON EITHER SIDE. FIT ONE PANEL AT A TIME SEE FIG.2, USING FIXING BOLTS O270-188. **NOTE:** MULTIPLE UNITS, SECURE TWO PANELS SIDE BY SIDE SEE FIG.3.

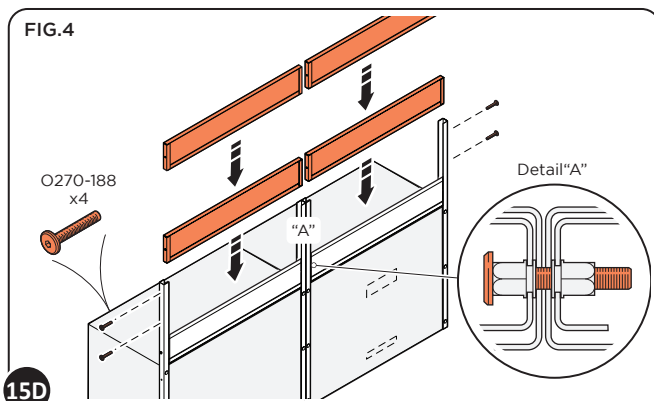

15D **NOTE:** MAKE SURE ALL PANELS ARE ALIGNED AND LEVEL, SECURING A PANEL AT A TIME, FOLLOW FIG.1 TO FIG.4.

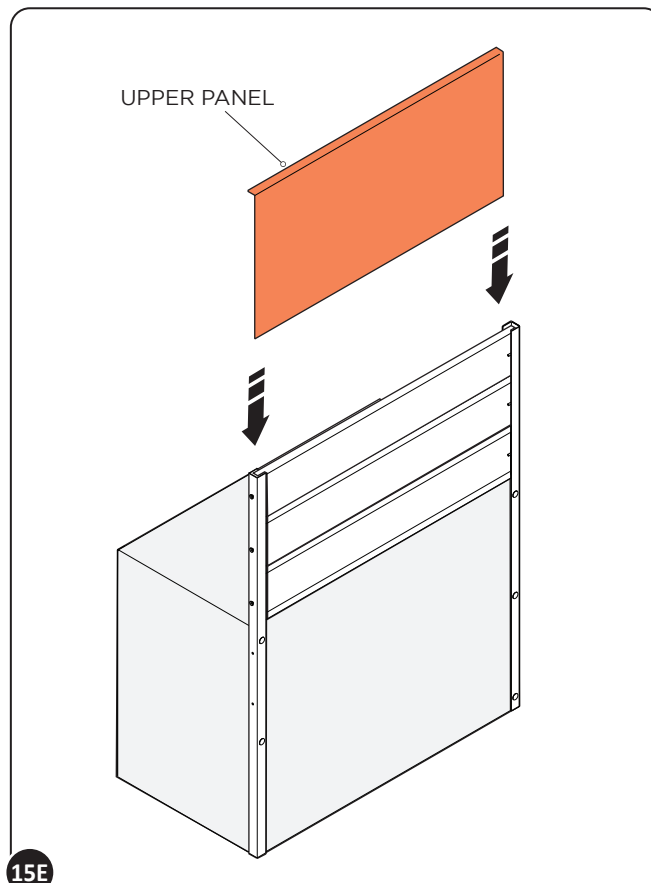

15E LOCATE UPPER BACKING PANEL, CAREFULLY SLIDE LOWER IN BETWEEN UPRIGHT POSTS, AS SHOWN ABOVE.

16. BRAND PLATE INSTALLATION



Eye Protection Gloves

**IMPORTANT: WHEN DRILLING,
PPE MUST BE WORN!**

USE 4 MM
ALLEN KEY

O270-187

X2

KICKBOARD

16A

16B

16C

BRAND PLATE

FK4



**WE RECOMMEND YOU REMOVE THE
KICK BOARD FOR THIS PROCEDURE**

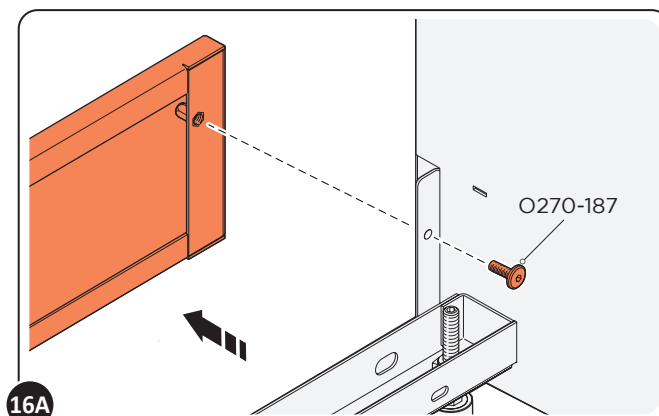

16A

LOCATE AND REMOVE KICK BOARD, BY UNSCREWING THE TWO FIXING
SCREWS, USING A 4 MM ALLEN KEY.

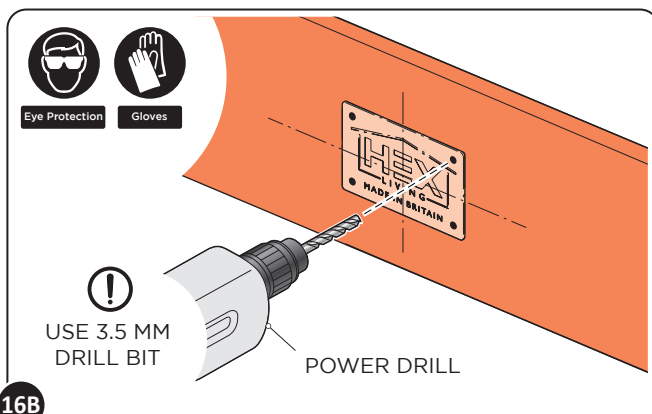

16B

POSITION THE BRAND PLATE CENTRALLY ON THE KICKBOARD AND
USE THE AS A TEMPLATE TO DRILL FOUR HOLES.

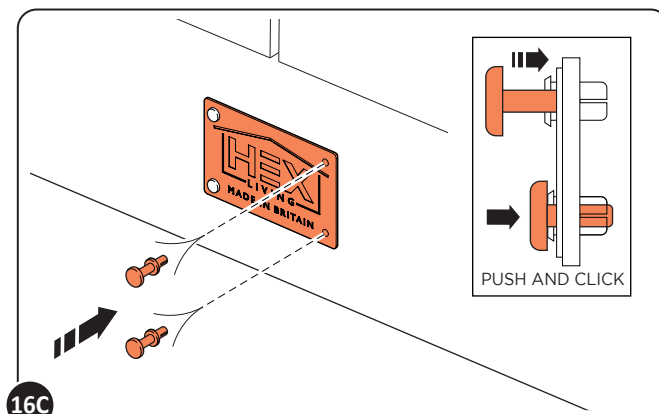

16C

SECURE BRAND PLATE TO KICKBOARD, SIMPLY USING 4 X PUSH IN
RIVETS. SECURE THE KICKBOARD TO THE CABINET BY REPEATING
STEP 17A.

17. FITTING A KITCHEN COVER (ACCESSORY)

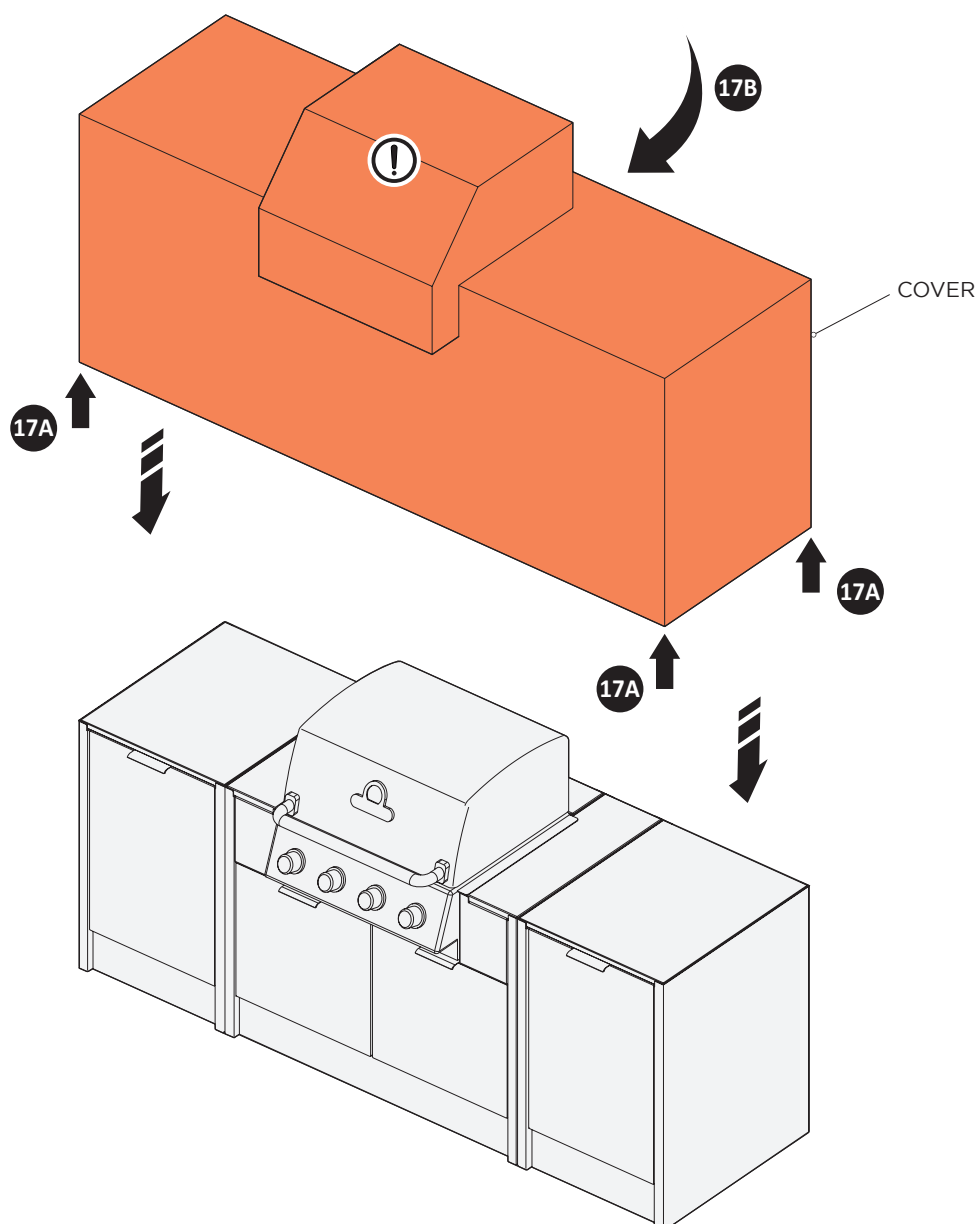

IMPORTANT: WHEN SECURING THE COVER ON YOUR PRODUCT, ENSURE IT DOES NOT CHAFE ON ANY SHARP EDGES.

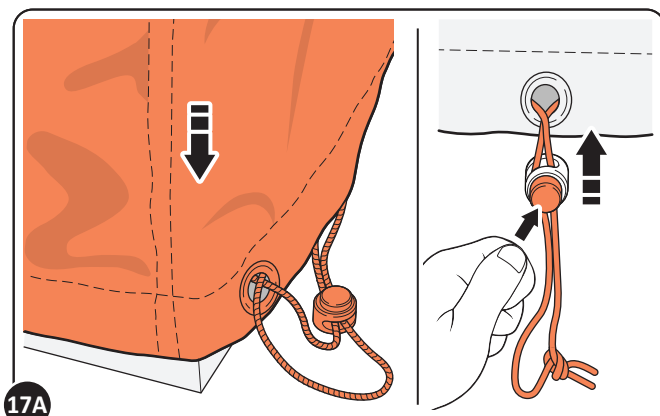

17A

PLACE WATERPROOF COVER, OVER KITCHEN AND TIGHTEN DRAW CORDS TO SECURE IN PLACE, AS SHOWN ABOVE.

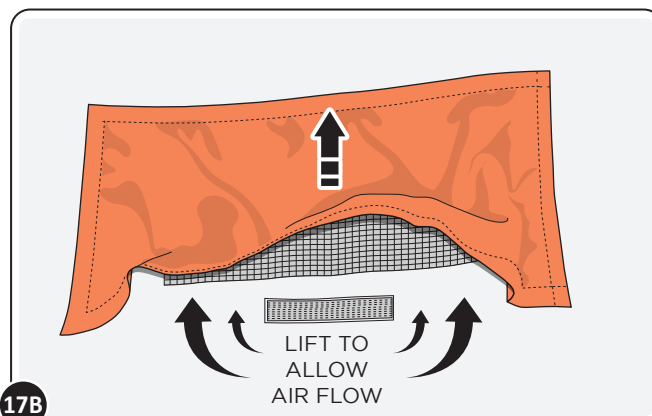

17B

OPENING AIR VENTS WILL HELP AIR CIRCULATION AND REDUCE MOISTURE BUILD-UP DUE TO TEMPERATURE CHANGES.

18. LIMITED WARRANTY

NOTE: A HEX LIVING WARRANTY INCLUDES MANUFACTURING DEFICIENCIES AND DEFECTIVE PARTS AND EXTENDS TO THE REPLACEMENT OF THESE PARTS. EXPENSES FOR SHIPPING, INSTALLATION, REPLACEMENT OF WORN PARTS AND OTHER COST ARE NOT COVERED BY THE WARRANTY. THE WARRANTY LAPSES IN CASE OF MISHANDLING AND IF ANY KIND OF UNAUTHORISED MODIFICATIONS ARE MADE TO THE APPLIANCE.

NOTES

This image shows a single sheet of white paper with horizontal ruling lines. The lines are evenly spaced and extend across the width of the page. There are no margins or other markings on the paper.